

WARNING: DEVIATION FROM THESE INSTALLATION INSTRUCTIONS MAY LEAD TO IMPROPER ENGINE OPERATION WHICH COULD CAUSE PERSONAL INJURY TO OPERATORS OR OTHER NEARBY PERSONNEL.

1.0 OVERVIEW

- 1.1 The Altronic SaveAIR® starting system has been designed for application on large, natural gas fueled engines and integral compressors which use in-head air starting. The SaveAIR system is field-programmable and provides start air valve control and cranking speed control as well as diagnostic features. This manual provides instruction and maintenance information for the SaveAIR. It is recommended that the user read this manual in its entirety before commencing operations.

CAUTION: Do **NOT** attempt to operate, maintain, or repair the SaveAIR unit until the contents of this document have been read and are thoroughly understood.

- 1.2 The SaveAIR system is normally used with high pressure compressed air. High pressure compressed air, when contained within an enclosure such as a reciprocating engine or its tubing system, can explode in a violent manner.

WARNING: It is necessary to always use extreme caution when working with any high pressure system.

- 1.3 The SaveAIR starting system is a gas engine accessory designed to be used as the cranking control on reciprocating natural gas engines with in-head air starting. The SaveAIR system controls both the timing and duration of the air pulse to the cylinders. The system controls air flow to the cylinders by opening and closing a pilot duty solenoid valve for each cylinder.

- 1.4 The SaveAIR system consists of three main parts:
- Logic Module Assembly 291300-xxx (application specific);
 - Output Module Assembly 291301-1 (10 outputs) or 291301-2 (20 outputs);
 - Display Module 291302-1.

The system also requires the following harnesses:

- One 293031-xx to connect the Logic Module to the Output Module;
- One 293034-48 to connect the Output Module to the Display Module;
- One or two 29302x-16 harnesses to connect the Output Module to the solenoid valves. One solenoid valve is required for each output to be used by the system.

- 1.5 The SaveAIR Display Module accomplishes all necessary input programming and data value read outs. The Display Module design allows remote mounting at the operating or shutdown panel board of the engine. RS-485 serial communications will allow up to 350 foot distance for the remote terminal location.

2.0 MOUNTING LOGIC/DISTRIBUTION MODULE ASSEMBLY

- 2.1 The 291300-xxx Logic/Distribution Module Assembly and all other components should be inspected immediately after unpacking. Check for any damage that may have occurred during shipping. If there are any questions regarding the physical integrity of the components, call the Altronic distributor that supplied the system. If possible, keep the original shipping container. If future transportation or storage of the Logic/Distribution Module is necessary, this container will provide optimum protection.

Ensure that the Logic Module received matches the model no. (-xxx) listed on the packing list and purchase order. The SaveAIR system is CSA certified for Class I, Group D, Division 2 hazardous locations.

- 2.2 The 291300-xxx Logic/Distribution Module Assembly mounts in place of the existing air distributor unit which is driven by the end of the engine camshaft. On some engines a special drive adaptor is required. See the SaveAIR Application List or contact the Altronic distributor for details on adaptors. Before mounting the unit, check for on engine oil or water leaks which should be repaired before proceeding.
- 2.3 Rotate the engine to TDC (Top Dead Center) of the first cylinder in the firing order and remove the existing air distributor.
- 2.4 Place the SaveAIR Logic/Distribution Module in position with the coupling aligned and attach it to the engine (or the adapter) using the original (or supplied) bolts. The 291300-xxx Logic Module should be oriented to locate the oil drain plug and connector pointed toward the floor. Removal of the oil drain plug may be helpful when aligning/engaging the coupling.

3.0 MOUNTING THE OUTPUT MODULE

- 3.1 The harness 293031-xx, which connects the Logic/Distribution Module to the 291301-x SaveAIR Output Module, is available in lengths of 24, 48, 72 inches. Select a location to mount the Output Module which is on or near to the engine and within a suitable distance to connect to the Logic Module using a harness of the appropriate length.
- 3.2 The Output Module should be located away from any extreme sources of heat. The operating ambient temperature range is -40°F to +185°F / -40°C. to +85°C. Do not expose the Output Module to temperatures higher than those indicated here.

4.0 MOUNTING THE SaveAIR DISPLAY MODULE

- 4.1 Mount the 291302-1 SaveAIR Display Module inside a control panel or to a suitable flat surface, preferably off the engine, in such a manner as to minimize exposure to vibration. The Display Module should be mounted so that the display is at a convenient viewing height. Refer to drawing 299302 for mounting dimensions. A NEMA 3R housing (720004-1) is also available as an alternative mounting option for the Display Module (See drawing 799048).
- 4.2 The Display Module should be mounted within 50 feet (15m) of the other SaveAIR modules which are mounted on or very near the engine.
- 4.3 Operating temperature range of the Display Module is -40°F to 158°F (-40°C to 70°C). Humidity specification is 0 to 95%, non-condensing. Housed in an aluminum weatherproof enclosure, the SaveAIR Display Module is splash resistant; however, the mounting site should provide as much protection from inclement weather as is practical. Avoid mounting the LCD display and keypad in direct sunlight.

5.0 MOUNTING THE SOLENOID VALVES

- 5.1 Mount the 690017-1 solenoid valves at a convenient location for service near the OEM air start valves mounted on each cylinder head of the Cooper or other engines which use a pneumatic, pilot activated in-head air check valve. Pilot activated in-head valves can be identified as having two pipes; one large and one small.
- 5.2 On Clark engines a special valve assembly 690018-1 is used to replace the mechanically driven air start valve which is housed in an air chest assembly, typically mounted on the side of the engine. The 690018-1 assembly consists of a pilot duty solenoid valve connected to a pneumatically actuated, large area valve. The 690018-1 assembly is then connected to the cylinder head using high pressure flexible stainless steel tubing.
- 5.3 It is recommended that an in-line filter (part no. 615010) be installed in the air line supplying the control solenoid valves and in the outlet lines to each cylinder.

6.0 SYSTEM WIRING

- 6.1 GENERAL - The following instructions apply to the electrical requirements of the installation of the SaveAIR system. All efforts should be made to conform to the applicable electrical code with regard to hazardous environment installations.
- 6.2 WIRING PRACTICE - Take care not to damage wiring insulation and take precautions against damage from vibration, abrasion or liquids in conduits. In addition, DO NOT run low voltage power, current loop, or communications wires in the same conduit as the ignition wiring or other high energy wiring such as AC power, etc. Keep wires at least 12 inches away from all high voltage wiring.
- 6.3 LOGIC MODULE - Connect the 293031-xx harness to the SaveAIR Logic/Distribution Module and route the flexible conduit assembly along the engine to the mounting position of the SaveAIR Output Module, Altronic part number 291301-x. Both ends of harness are pre-terminated with 17 pin connectors.
- 6.4 SYSTEM POWER - The Output Module to Display Module harness 293034-xx will be used to accomplish all remaining electrical connections of the system of this section. Use wiring methods suitable for Class I, Division 2 locations for these connections from Output Module to the Display Module, power supply and digital/analog IO signals. Power input to the system is accomplished through wires marked G(+) and J(-) of the 293034-xx harness. A slow-blow 5 amp in-line fuse is required for the +24V "G" connection. It is suitable to obtain power from the same 24 volt source that is used for the Altronic Ignition (example CPU-2000).
- 6.5 DIGITAL INHIBIT INPUT - Connection of the digital input is accomplished through the wire marked "D" of harness 293034-xx connected to the Output Module. When the digital inhibit input is configured as "ON", the starter will be disabled unless this input is connected to the power ground by means of a manual switch or automation relay. This input would typically be controlled by the engine start panel or automation system.
- 6.6 DIGITAL PURGED OUTPUT - Connection of the isolated dry contact digital output is accomplished through the wires marked "E" and "F" of the harness 293034-xx connected to the Output Module. The output will close to indicate that the starting system has completed the configurable requirements of being purged.
- 6.7 ANALOG INPUT - Connection of the analog input is accomplished through the wire marked "C" of harness 293034-xx connected to the Output Module. Configured as a current loop having a 200 ohm receiving resistance, this input may be used for applications which would require an air start pressure sensor to inhibit or trigger a start attempt.
- 6.8 DISPLAY MODULE - The Output to Display harness 293034-xx is pre-wired with 50 feet of four-conductor shielded cable (P/N 503194-500) which provides power and RS-485 signals to the Display Module. This shielded cable should be routed in conduit to the display location and connected to the terminal strip of the Display Module per drawing 209304. Power is provided on pin "H" (red wire +24), pin "K" (black wire com). RS-485 connections are provided on pin "B" (white wire +) and pin "A" (green wire -).

IMPORTANT: Power for the Display Module must come from the SaveAIR Output Module.

7.0 WIRING THE SOLENOID VALVES

- 7.1 Route the primary harness(es) 29302x-16 from the Output Module to a junction box. Use wiring methods suitable for Class I, Division 2 locations (for example flexible or rigid conduit) from the junction box to the solenoid valves. The wire used should be 16 AWG such as Altronic 503188. The valves are wired to operate in sequence just like the ignition system. The SaveAIR Output Module always outputs in the same sequence.

- 7.2 Determine the proper wiring of the solenoids by writing in the engine firing order.

For the 291301-1 (10-output) module:

A - B - C - D - E - F - G - H - J - K

— — — — — — — — — — Write In the Engine Firing Order

For the 291301-2 (20-output) module (A1 is connector 1, A pin; A2 is connector 2, A pin):

A1-A2- B1-B2-C1-C2-D1-D2- E1-E2- F1-F2- G1-G2-H1-H2- J1-J2- K1-K2

— Engine Order

- 7.3 Connect the harness leads in the junction box in accordance with the engine firing order as determined above. The leads from the junction box corresponding to the system outputs connect to the solenoid coil (+) lead. The (-) lead of each solenoid connects to the common "P" lead and to the engine ground in the junction box.

8.0 UNDERSTANDING THE HOME SCREEN

- 8.1 The home screen is designed to provide indication of the current status as well as critical operational characteristics. The template for the home screen includes a text description of the current SaveAIR state. The template also includes numerical values for current engine position (POS), Engine RPM and supply pressure if the sensor is enabled. If starting is being inhibited the source of the inhibit is shown on line 2 as a "WAIT=" statement.

```
STATUS POS    RPM
ON DURATION°  PSI
```

```
STATUS POS    RPM
WAIT=CAUSE
```

- 8.2 The example of the home screen below depicts an engine rolling with the crankshaft position of 300 degrees and the start system turning the engine 20 RPM by actuating the starting valves for a duration of 80 degrees. The second screen depicts the addition of the Air Starter Pressure 165 psi when a pressure sensor is connected and enabled.

```
ROLLING 300°  20
ON 80°
```

```
ROLLING 300°  20
ON 80°        165
```

Definitions of the status words and conditions are provide below:

READY	Engine is Stopped, and conditions are ready to start.
NotRDY	Engine is Stopped, but a condition violates ready requirements.
TRYING	Starter is actuating outputs, but engine is not yet turning.
ROLLING	Engine Rotation is detected, but speed is too slow to begin purging.
PURGING	Engine is rotating with "RUN" output off to purge cylinders of residual fuel.
STARTING	Engine is now purged, digital output is on, waiting for ignition/fuel.
FIRING	Valve "ON" duration at 0 deg, RPM programmed in table is reached.
RUNNING	Firing state has persisted for RunCycles setting, starter is locked out.

- 8.3 When the engine is not running and the air starter is not active, the home screen will display either READY or NotRDY. The example home screens below depict the two possible stopped engine READY conditions. The lower lines indicate that the Digital Control Input is now open, or the air supply pressure is low, inhibiting the system from attempting a start.

```
READY    220°    0
WAIT=DIGopen
```

```
READY    220°    0
WAIT=AirLow    0
```

- 8.4 The NotRDY home screen example below depicts the stopped engine NOT READY condition that indicates that a start attempt will not begin until this unexpected condition is corrected.

```
NotRDY  220°    0
WAIT=RETRY
```

Definitions of the reasons for “WAIT” with the status reading “NotRDY” are listed below.

RETRY	Engine was running, starter waiting for new start command.
Backward	Engine rolled backwards.
FluxLO	Internal SaveAIR problem, requires service.
FluxHI	Internal SaveAIR problem, requires service.
FluxDELT	Internal SaveAIR problem, requires service.
TblErr A	Firing pattern table angles out of order
TblErr I	INITIATE table RPM values out of order.
TblErr D	DURATION table RPM values out of order.
AirErrSS	Air thresholds for stop, start or reset are out of order.

- 8.5 The Trying screen example below will be presented when a start is initiated and the engine has not yet begun to rotate. At this point, solenoids would be energized, trying to rotate the engine.

```
TRYING  220°    0
ON 110°    RPM
```

- 8.6 The ROLLING screen example below will be presented when rotation below the PURGE RPM setpoint is detected. The engine is turning but the speed is not sufficient to begin the purge cycle. If the speed drops back to zero, the state will return to TRYING.

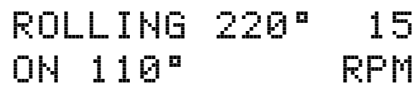
A rectangular display box with a black border and a drop shadow. It contains two lines of text in a monospaced font. The first line shows 'ROLLING' followed by '220°' and '15'. The second line shows 'ON 110°' followed by 'RPM'.

ROLLING 220° 15
ON 110° RPM

- 8.7 The PURGING cycle is started when the RPM is above the PURGE RPM setpoint. The purge counter counts engine cycles until the purge count is reached. When the PURGE count is completed, the digital output will turn ON to signal that the engine is ready for fueling. If the speed drops below the PURGE RPM setpoint, the purge counter will restart from zero.

A rectangular display box with a black border and a drop shadow. It contains two lines of text in a monospaced font. The first line shows 'PURGING' followed by '40'. The second line shows 'ON 90°' followed by 'RPM'.

PURGING 40
ON 90° RPM

- 8.8 The STARTING state display indicates that the PURGING cycle is complete and the spark/fuel request output has been activated.

A rectangular display box with a black border and a drop shadow. It contains two lines of text in a monospaced font. The first line shows 'STARTING' followed by '60'. The second line shows 'ON 80°' followed by 'RPM'.

STARTING 60
ON 80° RPM

- 8.9 The FIRING state display indicates that the engine has obtained Light-Off. This is defined to be the lowest RPM where the DURATION table value you have entered is equal to zero.

A rectangular display box with a black border and a drop shadow. It contains two lines of text in a monospaced font. The first line shows 'FIRING' followed by '90'. The second line shows 'ON 0°' followed by 'RPM'.

FIRING 90
ON 0° RPM

- 8.10 The RUNNING state display indicates that the engine is running and the transition from starting has been made. The Transition from FIRING to RUNNING is made when the starting valve duration has been at zero degrees for the number of RUN CYCLES programmed by the user. The starting cycle is now complete.

A rectangular display box with a black border and a drop shadow. It contains two lines of text in a monospaced font. The first line shows 'RUNNING' followed by '300'. The second line shows 'RPM'.

RUNNING 300
RPM

9.0 USING THE NORM KEY

- 9.1 From the READY or NotRDY screens, the history of the previous failed or aborted start attempt can be viewed by pressing the NORM key. The most common cause of a failed start attempt will have nothing to do with the starting system. As shown below, this start was aborted by opening the digital input. This would most likely be done by the operator or control panel to terminate a start attempt. As shown, the first press of the NORM key displays the reason for the abort, and a second press displays the status when the abort occurred. Pressing NORM a third time returns the home and WAIT cause.

```
READY  220°  0  
WAIT=DIGOpen
```

Press **NORM**

```
READY  220°  0  
ABORT=DIGOpen
```

Press **NORM**

```
READY  220°  0  
ABORT@Firing
```

- 9.2 In the second example below, the system was configured with a pressure sensor to control the start sequence. While the engine was being purged, the air supply pressure decreased below the Air.Stop setting, and the start was aborted due to low air supply pressure. The system will return to READY only if the digital input is opened or the pressure is decreased from 95psi to below the Air.Reset threshold. Either of these actions would create a new WAIT cause and permit the system to be READY again.

```
NotRDY  220°  0  
WAIT=RETRY  95
```

Press **NORM**

```
NotRDY  220°  0  
ABORT=AirLow
```

Press **NORM**

```
NotRDY  220°  0  
ABORT@PURGING
```

10.0 CONFIGURATION SCREENS FOR THE SaveAIR VARIABLES

- 10.1 The USER adjustable values are entered from the CONFIGURATION screens. These values must be programmed prior to trying to start the engine. These values are rarely adjusted in normal use and should be accessed only by qualified personnel. The CONFIGURATION values are divided into sub-menu groups by function. The group name appears on the top line of the display. The groups are: INITIATE TBL, DURATION TBL, TDC PATTERN, ENGINE Config, and SENSOR Config. When in the CONFIGURATION mode, the SETUP key can be used to move between sub-menu groups, the arrow keys to move between screens within a group, and the plus/minus keys to adjust the setting.

NOTE: Adjustable parameters are always pointed to by the → character.

Beginning at the HOME screen



READY 67° 0
WAIT=DIGOpen

To
configure
unit first
press

F1

then
press

F2

then
press

SETUP

- 10.2 Program the INITIATE table, this is the “turn on” or INITIATE angle for each valve versus an RPM curve defined by up to ten table points. The INITIATE angles are shown in degrees ATDC of all of the cylinders. Typically the INITIATE angle for the first value at 0 RPM will be the same used for other RPM entries (default of 5 deg. ATDC), or the smallest number of degrees ATDC in the table.



INITIATE TBL 1 5°
→ 0rpm

press to
decrease
value

-

press to
increase
value

+

Press the **NEXT** key to advance to the next value



INITIATE TBL 1 5°
0rpm →

press to
decrease
value

-

press to
increase
value

+

There are up to ten different RPM values which can be selected by the user. It is recommended that the default settings of this table be used for the first starting attempts until the user becomes familiar with the operation of the SaveAIR system.

- 10.3 After completing the INITIATE table, press the **SETUP** key to move to the DURATION table. The DURATION table defines the desired “ON ANGLE” (pulse width) for the air start valves in terms of engine degrees versus the engine RPM. The first value is the number of engine degrees to leave the valves open when the engine is stopped and is typically the largest DURATION in degrees. The DURATION curve versus RPM is defined by the table of ten USER programmed points. It is also suggested that the Default values be used as an initial starting point for a new installation. By reducing the pulse width in degrees of DURATION as the engine RPM increases, the USER can govern the maximum RPM the engine will crank and maximize the length of time that the engine will crank on a given volume of air. Additionally, the consistency of the cranking RPM lends itself to much better control of the starting conditions such as air/fuel ratio and improves the reliability of starting in general.



Press **NEXT** key to advance to the next value in the table. Remember that the RPM value which has a DURATION value of zero degrees will be the value used to determine that the engine is FIRING and (after the programmed number of engine cycles) that the engine condition is now RUNNING.

- 10.4 After completing the DURATION table, press the **SETUP** key to move to the engine crankshaft TDC PATTERN table. This table is programmed with the firing pattern of the engine in crankshaft degrees. Starting with the first cylinder in the pattern (A or A1) at zero degrees, enter the TDC position of the following cylinders equipped with air start valves as they appear in the firing order. Remember 2-stroke cycle engines complete a cycle every 360 degrees and 4 stroke cycle engines every 720 degrees of crankshaft rotation.



Press **NEXT** key to advance to the next value.



Complete the table for all cylinders with air start valves.

- 10.5 Press the **SETUP** key to advance to the ENGINE CONFIG table. The first screen is used to tell the SaveAIR control how it is aligned to the engine position. The engine should be sitting at TDC of the first cylinder in the firing order per section 2.3 of these instructions. Please confirm this position.

<div>ENGINE AT 120° LineUpCal → 0°</div>	press to decrease value	<div>-</div>	press to increase value	<div>+</div>
--	-------------------------------	--------------	-------------------------------	--------------

Using the +/- keys adjust the LINE UP CAL value until the ENGINE AT value is zero. Then press the **NEXT** key to select the Output Module type. Use the +/- keys to select either 291301-1 with ten outputs or 291301-2 with twenty outputs.

<div>ENGINE Config Module →291301-1</div>	press to decrease value	<div>-</div>	press to increase value	<div>+</div>
---	-------------------------------	--------------	-------------------------------	--------------

Press the **NEXT** key to advance to the next engine configuration screen. Select the number of starting valves being used.

<div>ENGINE Config NumValves → 6</div>	press to decrease value	<div>-</div>	press to increase value	<div>+</div>
--	-------------------------------	--------------	-------------------------------	--------------

Press the **NEXT** key to advance to the next engine configuration screen. Select the direction of engine rotation CW or CCW. This is the normal direction of rotation of the logic unit viewed from its drive end when the engine is running. Selected value is shown in CAPITAL letters.

<div>ENGINE Rotation → cw/CCW 25.00</div>	press to select CCW	<div>-</div>	press to select CW	<div>+</div>
---	---------------------------	--------------	--------------------------	--------------

Press the **NEXT** key to advance to the next engine configuration screen. Select the engine type 4 cycle or 2 cycle. Selected value is shown in CAPITAL letters.

<div>ENGINE Config → 4cycle/2CYCLE</div>	press to select 2CYCLE	<div>-</div>	press to select 4CYCLE	<div>+</div>
--	------------------------------	--------------	------------------------------	--------------

Press the **NEXT** key to advance to the next engine configuration screen. Select the INHIBIT starting by DIGITAL input ON or OFF. Selected value is shown.

ENGINE Config Inhibit DIG →ON	press to select OFF	-	press to select ON	+
----------------------------------	---------------------------	---	--------------------------	---

Press the **NEXT** key to advance to the next engine configuration screen. Select the INHIBIT starting by Air Supply Pressure input ON or OFF. Selected value is shown. When ON, the home screen will include the measured pressure on the bottom right.

ENGINE Config Inhibit Air →OFF	press to select OFF	-	press to select ON	+
-----------------------------------	---------------------------	---	--------------------------	---

Press the **NEXT** key to advance to the next engine configuration screen. Select the PURGE RPM. This is the lowest RPM where purge cycles will be counted. Selected value is shown.

ENGINE Config PurgeRPM → 25	press to decrease value	-	press to increase value	+
--------------------------------	-------------------------------	---	-------------------------------	---

Press the **NEXT** key to advance to the next engine configuration screen. Select the number of PURGE cycles completed before the SaveAIR output shows PURGE complete. Selected value is shown.

ENGINE Config PurgeCycles → 5	press to decrease value	-	press to increase value	+
----------------------------------	-------------------------------	---	-------------------------------	---

Press the **NEXT** key to advance to the next engine configuration screen. Select RunCycles, the number of engine cycles completed with the starting air valves having an ON duration of zero degrees before the engine is considered to be running under its own power and the starting system is locked out until a new starting sequence is attempted.

ENGINE Config RunCycles → 10	press to decrease value	-	press to increase value	+
---------------------------------	-------------------------------	---	-------------------------------	---

- 10.6 If the optional air pressure sensor is used, press the **SETUP** key to move to the SENSOR CONFIGURATION table. Set the Minimum Air Supply Pressure to begin a starting attempt. The current value being measured is shown on the top line of the display.



Press the **NEXT** key to move to the next value. Set the Minimum Air Supply Pressure to continue cranking after a start sequence has begun, before a start attempt is aborted.



Press the **NEXT** key to move to the next value. Set the Air Supply Pressure to RESET the system for a new cranking attempt after a start sequence has ended. Pressure must drop below this value before a new start attempt is allowed.



Press the **NEXT** key to move to the sensor SPAN calibration. The SaveAIR unit is made to be used with an optional 4-20 milliamp transmitter to monitor air pressure. The input is designed for a single wire connection from the transmitter through an internal 200 ohm receiving resistor to ground. SPAN is the slope calibration point and should be equal to the full scale psi X 1.5625. Example shows the values for a 500 PSIG transducer.



Press the **NEXT** key to move the sensor ZERO calibration. This should be the value corresponding to zero volts coming from the sensor. For the 500 PSIG sensor this is equal to $(-0.25 \times 500) = -125$



11.0 ADDITIONAL PARAMETER VIEW SCREENS

- 11.1 Additional parameters of interest can be selected for view by pressing the PREV or NEXT key to rotate through the various screens.



```
TRYING 220° 0
ON 110° RPM
```

- 11.2 The first parameter view screen identifies the solenoid valve outputs which are being energized. The #1 and #2 depict the two connectors of the 20 output module. Only the top line will be displayed for the 10 output module. In the example shown, output pin A and B of connector #1 and pin A of connector #2 are turned on.

Press **NEXT**

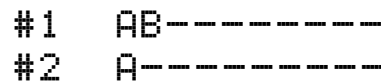

```
#1 AB-----
#2 A-----
```

- 11.3 The second parameter view screen provides a flux magnitude value which can be helpful in diagnosing a mis-assembled Logic/Distribution Module. The bottom line of the active home screen is replaced as shown below. Acceptable flux values are from 5 to 25 and not varying more than 5 in a single rotation.

Press **NEXT**



```
TRYING 220° 0
EncoderFlux 14
```

- 11.4 The next parameter view screen provides the system supply voltage value which can be helpful in diagnosing installation or supply voltage problems. The bottom line of the active home screen is replaced as shown below.

Press **NEXT**



```
TRYING 220° 0
SUPPLY 24.2volts
```

- 11.5 The final parameter view screen provides a voltage and current description of the analog air pressure sensor input. These values can be helpful in diagnosing and calibrating the air pressure sensor. The bottom line of the active home screen is replaced as shown below.

Press **NEXT**



```
TRYING 220° 0
Air0.00V/ 0.03ma
```

- 11.6 Pressing NEXT again returns the screen shown as shown in 11.1.

12.0 TEST MODE DIAGNOSTIC FUNCTION SCREEN

- 12.1 The Test Mode diagnostic function can be used to actuate all of the outputs or a specific output for the purpose of troubleshooting the valve wiring. From the READY home screen press SETUP to access the test mode screen and use the plus/minus keys to activate and select the Test Mode.



```
READY  220°  0
WAIT=DIGOpen
```

Press **SETUP**



```
TestMode
→ OFF
```

- 12.2 The ALL Test Mode will pulse all of the valves in order, switching to the next valve each ~200mS and keeping the valve on for ~50mS.

Press **+**



```
TestMode
→ ALL (In Order)
```

- 12.3 The individual output Test Mode will pulse a specific valve every ~200mS for ~50mS.

Press **+**



```
TestMode
Pulsing Pin → A
```

Press **+**



```
TestMode
Pulsing Pin → B
```

- 12.4 Operation of the Test Mode will be terminated by detection of engine rotation, by any status change from the READY state, or by pressing the Normal key. Operation of Test Mode will time out after 10 minutes of no key activity. The NotRDY message shown below will indicate that the test mode is inhibited because the status is not READY.



```
TestMode
OFF (NotRDY)
```

13.0 USING THE SaveAIR TERMINAL PC PROGRAM

- 13.1 Included with the SaveAIR system is an optional use PC Terminal Program. The terminal program may be used to program and troubleshoot an installation initially or it can be used to monitor the operation via a personal computer on a long term basis. The terminal program is stored on the CDrom disc shipped with the SaveAIR system and will auto install on an IBM compatible computer using the WINDOWS operating systems: 95, 98, ME, XP, and 2000.
- 13.2 The SaveAIR Logic/Distribution Module includes one half-duplex RS-485 9600,N,8,1 communications port which always functions as a MODBUS slave that can support ONE master device.
- 13.3 The Display Module, PC Terminal Program or MODBUS equipped PLC will always function as the communications master. One and only one master is permitted on the bus at a time. Therefore, the Display Module must be disconnected anytime an alternate device such as a PC or PLC is in use.
- 13.4 An RS-485 adapter is required to connect the PC to the SaveAIR serial port. The recommended RS-232 to RS-485 converter is the B&B Electronics Model 4WSD9R with switches set as follows (RS-485, EchoOFF, 2wire, 2wire).
- 13.5 The operation of the terminal program is, for the most part, self-evident. Where additional information would be helpful to the first time user, it is included as Windows Tool Tips. These tips are ballooned text messages which appear when the mouse pointer is hovered over various target items of the screen.
- 13.6 Menu activated advanced user features are listed below.
- | | |
|---------------|---|
| CHART | Real time graphical display of starter related data. |
| ROI | Remote Operator Interface - Display Module emulation. |
| DEVICE CONFIG | Save, Read, Send Configuration Data Files. |
| SNAPSHOT | Save snapshot of current screen to .jpg file. |
| LOGFILE | Save real time starter data to comma delimited .csv file. |

14.0 MODBUS REGISTER LIST

REG00001	"Test Digital In 1 Permissive "
REG00002	"Test Air Pressure Permissive "
REG00003	"Engine Type 1=4cycle 0=2cycle "
REG00004	"InputShaft Rotation 1=CW 0=CCW"
REG00005	"RESERVED "
REG00006	"RESERVED "
REG00007	"RESERVED "
REG00008	"ROI active on RTU port 1=ON "
REG00009	"RESERVED "
REG00010	"RESERVED "
REG00011	"RESERVED "
REG00012	"RESERVED "
REG00013	"RESERVED "
REG00014	"RESERVED "
REG00015	"RESERVED "
REG00016	"RESERVED "

REG10001	"Digital Input #1 Inhibit"
REG10002	"Air Supply Pressure Inhibit"
REG10003	"Duration vs RPM = 0 Inhibit"
REG10004	"Restart Inhibit"
REG10005	"Energizing Solenoids Now "
REG10006	"Digital In #1 Grounded Status "
REG10007	"Air Supply>start Status "
REG10008	"Air Supply>stop Status "
REG10009	"CFGERR TDC Tbl AngleOrderEven"
REG10010	"CFGERR TDC Tbl AngleOrderOdd "
REG10011	"CFGERR INITIATE Tbl RPM order"
REG10012	"CFGERR DURATION Tbl RPM order"
REG10013	"CFGERR Air.Start < Air.Stop "
REG10014	"FluxLO Magnet Gap too small"
REG10015	"FluxHI Magnet Gap too large"
REG10016	"FluxDELTA Magnet Off Center "
REG10017	"MUX ac A PIN AT MICRO WIRE=K"
REG10018	"MUX ac B PIN AT MICRO WIRE=L"
REG10019	"MUX ac C PIN AT MICRO WIRE=M"
REG10020	"MUX bd A PIN AT MICRO WIRE=N"
REG10021	"MUX bd B PIN AT MICRO WIRE=P"
REG10022	"MUX bd C PIN AT MICRO WIRE=R"
REG10023	"Purged Output Pin WIRE=?"
REG10024	"Running "
REG10025	"FIREA PIN AT MICRO WIRE=A"
REG10026	"FIREB PIN AT MICRO WIRE=B"
REG10027	"FIREC PIN AT MICRO WIRE=C"
REG10028	"FIRED PIN AT MICRO WIRE=D"
REG10029	"Valve Output 1 Harness Pin 1A"
REG10030	"Valve Output 2 Harness Pin 2A"
REG10031	"Valve Output 3 Harness Pin 1B"
REG10032	"Valve Output 4 Harness Pin 2B"
REG10033	"Valve Output 5 Harness Pin 1C"
REG10034	"Valve Output 6 Harness Pin 2C"
REG10035	"Valve Output 7 Harness Pin 1D"
REG10036	"Valve Output 8 Harness Pin 2D"
REG10037	"Valve Output 9 Harness Pin 1E"
REG10038	"Valve Output 10 Harness Pin 2E"
REG10039	"Valve Output 11 Harness Pin 1F"
REG10040	"Valve Output 12 Harness Pin 2F"
REG10041	"Valve Output 13 Harness Pin 1K"
REG10042	"Valve Output 14 Harness Pin 2K"

```

REG10043 "Valve Output 15 Harness Pin 1L"
REG10044 "Valve Output 16 Harness Pin 2L"
REG10045 "Valve Output 17 Harness Pin 1M"
REG10046 "Valve Output 18 Harness Pin 2M"
REG10047 "Valve Output 19 Harness Pin 1N"
REG10048 "Valve Output 20 Harness Pin 2N"
REG10049 "EEUPDATED time to read 4xxxx's"
REG10050 "RESERVED"
REG10051 "RESERVED"
REG10052 "RESERVED"
REG10053 "RESERVED"
REG10054 "RESERVED"
REG10055 "RESERVED"
REG10056 "RESERVED"
REG10057 "RESERVED"
REG10058 "RESERVED"
REG10059 "RESERVED"
REG10060 "RESERVED"
REG10061 "RESERVED"
REG10062 "RESERVED"
REG10063 "RESERVED"
REG10064 "RESERVED"

REG30001 "mirror of inputs 10016-10001"
REG30002 "mirror of inputs 10032-10017"
REG30003 "mirror of inputs 10048-10033"
REG30004 "mirror of inputs 10064-10049"
REG30005 "mirror of inputs 10080-10065"
REG30006 "mirror of inputs 10096-10081"
REG30007 "mirror of inputs 10112-10097"
REG30008 "mirror of inputs 10128-10113"
REG30009 "Electronic Air Start STAT code"
REG30010 "Electronic Air Start WAIT code"
REG30011 "ENCODER ANGLE DEG"
REG30012 "ENCODER FLUX (0-31)"
REG30013 "Engine Angle DEG"
REG30014 "Engine RPM RPM"
REG30015 "INITIATE Angle DEG"
REG30016 "DURATION Angle DEG"
REG30017 "Air Sensor Voltage volts*100"
REG30018 "Air Sensor Current mA*100"
REG30019 "Air Sensor Pressure psig*10"
REG30020 "SUPPLY VOLTAGE 24V volts*10"
REG30021 "CYCLE COUNTER cycles"
REG30022 "Electronic Air Start STOP=code"
REG30023 "Electronic Air Start STOP@code"
REG30024 "Aux 1 Signal Output mA*100"
REG30025 "Aux 2 Signal Output mA*100"

REG40001 "mirror of coils 00016-00001" LIM={00000,65535} DEF=( 1)
REG40002 "mirror of coils 00032-00017" LIM={00000,65535}
REG40003 "mirror of coils 00048-00033" LIM={00000,65535}
REG40004 "mirror of coils 00064-00049" LIM={00000,65535}
REG40005 "mirror of coils 00080-00065" LIM={00000,65535}
REG40006 "mirror of coils 00096-00081" LIM={00000,65535}
REG40007 "mirror of coils 00112-00097" LIM={00000,65535}
REG40008 "mirror of coils 00128-00113" LIM={00000,65535}
REG40009 "NUMBER OF OUTPUTS USED" LIM={ 3, 20} DEF=( 8)
REG40010 "ENCODER CAL ANGLE" LIM={ 0, 719} DEF=( 0)
REG40011 "Min Speed for Valid Purge RPM" LIM={ 0, 200} DEF=( 30)
REG40012 "Cycles to Purge CYC" LIM={ 0, 20} DEF=( 4)
REG40013 "AirOff Cycles Before Run CYC" LIM={ 0, 500} DEF={ 30}
REG40014 "Output Module Type dash 1 or 2" LIM={ 1, 2} DEF={ 1}
REG40015 "Air Supply Start > xxx.x psi" LIM={00000,32767} DEF={ 1000}
REG40016 "Air Supply Stop < xxx.x psi" LIM={00000,32767} DEF={ 800}
REG40017 "Air Supply Reset < xxx.x psi" LIM={00000,32767} DEF={ 50}

```

REG40018	"Air Supply Pres Sensor Span	" LIM={ 1,32767} DEF={ 7813}
REG40019	"Air Supply Pres Sensor Zero	" LIM={-32768,32767}DEF={-1250}
REG40020	"TDC OF CYL01/OUTPUT A OR 1A	" LIM={ 0, 720} DEF={ 0}
REG40021	"TDC OF CYL02/OUTPUT B OR 2A	" LIM={ 0, 720} DEF={ 45}
REG40022	"TDC OF CYL03/OUTPUT C OR 1B	" LIM={ 0, 720} DEF={ 90}
REG40023	"TDC OF CYL04/OUTPUT D OR 2B	" LIM={ 0, 720} DEF={ 135}
REG40024	"TDC OF CYL05/OUTPUT E OR 1C	" LIM={ 0, 720} DEF={ 180}
REG40025	"TDC OF CYL06/OUTPUT F OR 2C	" LIM={ 0, 720} DEF={ 225}
REG40026	"TDC OF CYL07/OUTPUT G OR 1D	" LIM={ 0, 720} DEF={ 270}
REG40027	"TDC OF CYL08/OUTPUT H OR 2D	" LIM={ 0, 720} DEF={ 315}
REG40028	"TDC OF CYL09/OUTPUT J OR 1E	" LIM={ 0, 720} DEF={ 720}
REG40029	"TDC OF CYL10/OUTPUT K OR 2E	" LIM={ 0, 720} DEF={ 720}
REG40030	"TDC OF CYL11/OUTPUT 1F	" LIM={ 0, 720} DEF={ 720}
REG40031	"TDC OF CYL12/OUTPUT 2F	" LIM={ 0, 720} DEF={ 720}
REG40032	"TDC OF CYL13/OUTPUT 1G	" LIM={ 0, 720} DEF={ 720}
REG40033	"TDC OF CYL14/OUTPUT 2G	" LIM={ 0, 720} DEF={ 720}
REG40034	"TDC OF CYL15/OUTPUT 1H	" LIM={ 0, 720} DEF={ 720}
REG40035	"TDC OF CYL16/OUTPUT 2H	" LIM={ 0, 720} DEF={ 720}
REG40036	"TDC OF CYL17/OUTPUT 1J	" LIM={ 0, 720} DEF={ 720}
REG40037	"TDC OF CYL18/OUTPUT 2J	" LIM={ 0, 720} DEF={ 720}
REG40038	"TDC OF CYL19/OUTPUT 1K	" LIM={ 0, 720} DEF={ 720}
REG40039	"TDC OF CYL20/OUTPUT 2K	" LIM={ 0, 720} DEF={ 720}
REG40040	"INITIATE TABLE POINT 1 RPM	" LIM={ -1, 0} DEF={ 0}
REG40041	"INITIATE TABLE POINT 1 DEG	" LIM={ -300, 300} DEF={ 5}
REG40042	"INITIATE TABLE POINT 2 RPM	" LIM={ -1, 500} DEF={ 10}
REG40043	"INITIATE TABLE POINT 2 DEG	" LIM={ -300, 300} DEF={ 5}
REG40044	"INITIATE TABLE POINT 3 RPM	" LIM={ 0, 500} DEF={ 20}
REG40045	"INITIATE TABLE POINT 3 DEG	" LIM={ -300, 300} DEF={ 5}
REG40046	"INITIATE TABLE POINT 4 RPM	" LIM={ 0, 500} DEF={ 30}
REG40047	"INITIATE TABLE POINT 4 DEG	" LIM={ -300, 300} DEF={ 5}
REG40048	"INITIATE TABLE POINT 5 RPM	" LIM={ 1, 500} DEF={ 40}
REG40049	"INITIATE TABLE POINT 5 DEG	" LIM={ -10, 180} DEF={ 5}
REG40050	"INITIATE TABLE POINT 6 RPM	" LIM={ 1, 500} DEF={ 60}
REG40051	"INITIATE TABLE POINT 6 DEG	" LIM={ -10, 180} DEF={ 5}
REG40052	"INITIATE TABLE POINT 7 RPM	" LIM={ 1, 500} DEF={ 75}
REG40053	"INITIATE TABLE POINT 7 DEG	" LIM={ -10, 180} DEF={ 5}
REG40054	"INITIATE TABLE POINT 8 RPM	" LIM={ 1, 500} DEF={ 100}
REG40055	"INITIATE TABLE POINT 8 DEG	" LIM={ -10, 180} DEF={ 5}
REG40056	"INITIATE TABLE POINT 9 RPM	" LIM={ 1, 500} DEF={ 125}
REG40057	"INITIATE TABLE POINT 9 DEG	" LIM={ -10, 180} DEF={ 5}
REG40058	"INITIATE TABLE POINT 10 RPM	" LIM={ 1, 500} DEF={ 150}
REG40059	"INITIATE TABLE POINT 10 DEG	" LIM={ -10, 180} DEF={ 5}
REG40060	"DURATION TABLE POINT 1 RPM	" LIM={ -1, 0} DEF={ 0}
REG40061	"DURATION TABLE POINT 1 DEG	" LIM={ 0, 300} DEF={ 105}
REG40062	"DURATION TABLE POINT 2 RPM	" LIM={ -1, 500} DEF={ 10}
REG40063	"DURATION TABLE POINT 2 DEG	" LIM={ 0, 300} DEF={ 100}
REG40064	"DURATION TABLE POINT 3 RPM	" LIM={ 0, 500} DEF={ 20}
REG40065	"DURATION TABLE POINT 3 DEG	" LIM={ 0, 300} DEF={ 90}
REG40066	"DURATION TABLE POINT 4 RPM	" LIM={ 0, 500} DEF={ 30}
REG40067	"DURATION TABLE POINT 4 DEG	" LIM={ 0, 300} DEF={ 80}
REG40068	"DURATION TABLE POINT 5 RPM	" LIM={ 1, 500} DEF={ 40}
REG40069	"DURATION TABLE POINT 5 DEG	" LIM={ 0, 180} DEF={ 80}
REG40070	"DURATION TABLE POINT 6 RPM	" LIM={ 1, 500} DEF={ 60}
REG40071	"DURATION TABLE POINT 6 DEG	" LIM={ 0, 180} DEF={ 80}
REG40072	"DURATION TABLE POINT 7 RPM	" LIM={ 1, 500} DEF={ 75}
REG40073	"DURATION TABLE POINT 7 DEG	" LIM={ 0, 180} DEF={ 50}
REG40074	"DURATION TABLE POINT 8 RPM	" LIM={ 1, 500} DEF={ 100}
REG40075	"DURATION TABLE POINT 8 DEG	" LIM={ 0, 180} DEF={ 0}
REG40076	"DURATION TABLE POINT 9 RPM	" LIM={ 1, 500} DEF={ 125}
REG40077	"DURATION TABLE POINT 9 DEG	" LIM={ 0, 180} DEF={ 0}
REG40078	"DURATION TABLE POINT 10 RPM	" LIM={ 1, 500} DEF={ 150}
REG40079	"DURATION TABLE POINT 10 DEG	" LIM={ 0, 180} DEF={ 0}

SAVE*Air* Setup and Configuration WorkSheet

Customer: _____ Station: _____

Engine Model: _____ Unit No. _____

Installer: _____ Date: _____

Logic/Distribution Model: 291300- _____ SN: _____

Output Module Model: 291301- _____ SN: _____

Display Module Model: 201302-1 SN: _____

ENGINE CFG:

LineUpCal = _____

Module = _____

NumValves = _____

CW / CCW = _____

4Cyc/2Cyc = _____

InhibitDIG = _____

InhibitAIR = _____

PurgeRPM = _____

PurgeCycles = _____

RunCycles = _____

TDC PATTERN TBL:

PIN ANGLE CYLINDER

#1 A (A1) _____deg _____cyl

#2 B (A2) _____deg _____cyl

#3 C (B1) _____deg _____cyl

#4 D (B2) _____deg _____cyl

#5 E (C1) _____deg _____cyl

#6 F (C2) _____deg _____cyl

#7 G (D1) _____deg _____cyl

#8 H (D2) _____deg _____cyl

#9 J (E1) _____deg _____cyl

#10 K (E2) _____deg _____cyl

#11 (F1) _____deg _____cyl

#12 (F2) _____deg _____cyl

#13 (G1) _____deg _____cyl

#14 (G2) _____deg _____cyl

#15 (H1) _____deg _____cyl

#16 (H2) _____deg _____cyl

#17 (J1) _____deg _____cyl

#18 (J2) _____deg _____cyl

#19 (K1) _____deg _____cyl

#20 (K2) _____deg _____cyl

INITIATE TBL:

#1 _____rpm _____deg

#2 _____rpm _____deg

#3 _____rpm _____deg

#4 _____rpm _____deg

#5 _____rpm _____deg

#6 _____rpm _____deg

#7 _____rpm _____deg

#8 _____rpm _____deg

#9 _____rpm _____deg

#10 _____rpm _____deg

SENSOR CFG:

Air.Start = _____

Air.Stop = _____

Air.Reset = _____

Air.Span = _____

Air.Zero = _____

DURATION TBL:

#1 _____rpm _____deg

#2 _____rpm _____deg

#3 _____rpm _____deg

#4 _____rpm _____deg

#5 _____rpm _____deg

#6 _____rpm _____deg

#7 _____rpm _____deg

#8 _____rpm _____deg

#9 _____rpm _____deg

#10 _____rpm _____deg

SAVE*Air* Home Screen Status Messages

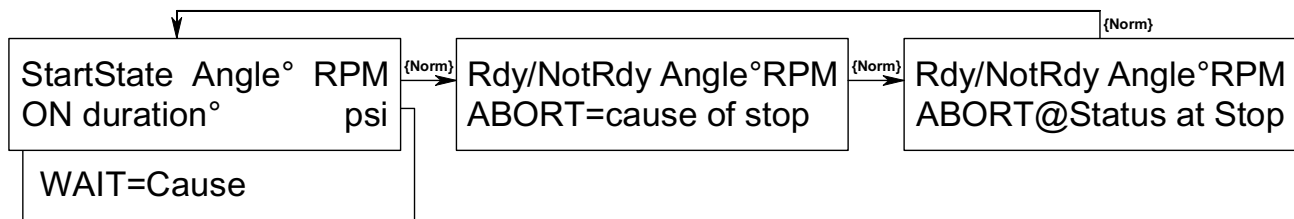

Next + Setup F1
Prev - Norm F2

READY 220° 0
WAIT=DIGopen Starter is Inhibited because Digital Input is not Grounded

TRYING 220° 0
110°@ 5° RPM Starter is actuating outputs but engine is not yet turning

ROLLING 35° 15
ON 110° RPM Starter is rolling the engine below purgeRPM threshold

PURGING 45
ON 90° RPM Starter is rolling the engine counting purge cycles

STARTING 50
ON 80° RPM Starter is rolling the engine Purge is done, output is on

FIRING 80
ON 0° RPM Duration is at zero because Combustion has occurred

RUNNING 195
RPM Duration has been at zero for RunCycles, starter is off

READY 220° 0
WAIT=AirLow 0 Starter is Inhibited because Air Supply Pressure is low. Value displayed on bottom line.

NotRDY 220° 0
WAIT=RETRY 95 Starter is Inhibited because of the previous start attempt. Inhibit Starter to reset.

NotRDY 220° 0
WAIT=FluxLO
WAIT=FluxHI
WAIT=FluxDELT Magnet is not present or Gap is Too large
Magnet is Too Strong or Gap is Too Small
Magnet is not in proper alignment

NotRDY 220° 0
WAIT=TblErr A
Wait=TblErr I
Wait=TblErr D
Wait=AirErrSS Pattern Table values are Out of Order
Initiate Table Err
RPM out of Order
Duration Table Err
RPM out of Order
Air Start,Stop,Reset are out of Order

READY 220° 0
ABORT=Powerup
ABORT@PowerUp

Abort history initialized on powerup of system

READY 220° 0
ABORT=STARTED
ABORT@FIRING

Last start was completed when engine started.

READY 220° 0
ABORT=DIGopen
ABORT@STARTING

Start aborted when DIG input was opened while engine was starting

NotRDY 220° 0
ABORT=AirLow
ABORT@PURGING

Termination of a start due to low Air Supply while purging the engine

READY 220° 0
ABORT=Backward
ABORT@TRYING

Start Aborted due to backward rotation when trying to start.

View Screens

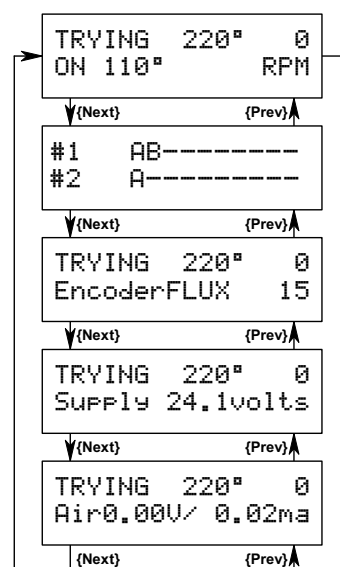



ID# 1 255 V1.6 03/29/2005 SaveAIR

ShowColors

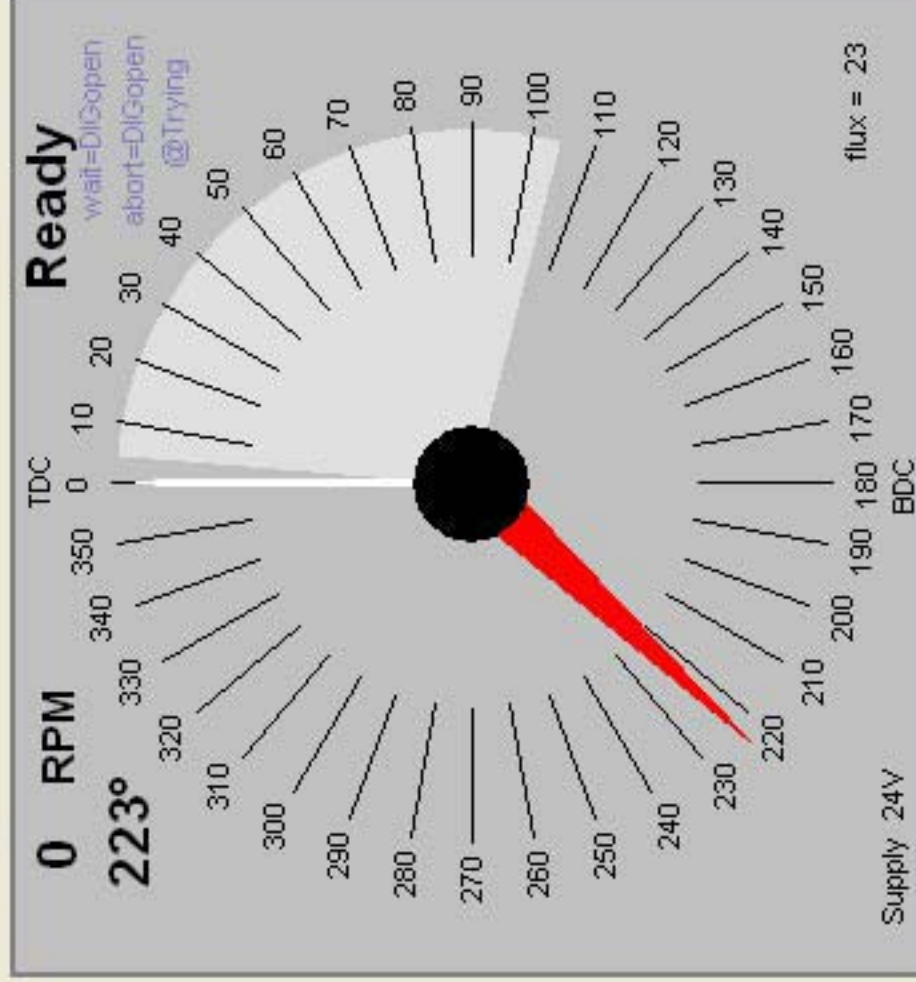

☐ Clockwise Rotation

☐ 4 Stroke (720°)

☒ Inhibit by Digital Input

☐ Inhibit by Supply Pressure

Purge RPM

Purge Cycles

Run Cycles

25

5

10

ASP Start

ASP Stop

ASP Rst

ASP Slope

ASP Offset

160.0

120.0

10.0

781.3

-125.0

-124.3

.02

PSI

mA

Lookup Table	INITIATE
Point# RPM	5
1	5
2	5
3	5
4	5
5	5
6	5
7	5
8	5
9	5
10	5

Lookup Table	DURATION
Point# RPM	100
1	100
2	100
3	90
4	80
5	80
6	80
7	50
8	0
9	0
10	0

#Outputs	10
Module 291301 -	1
LineUp	0
TDC PATTERN	
#1 [A]	0
#2 [B]	60
#3 [C]	72
#4 [D]	132
#5 [E]	144
#6 [F]	204
#7 [G]	216
#8 [H]	276
#9 [J]	288
#10 [K]	348

SAVE Air™

System Diagram

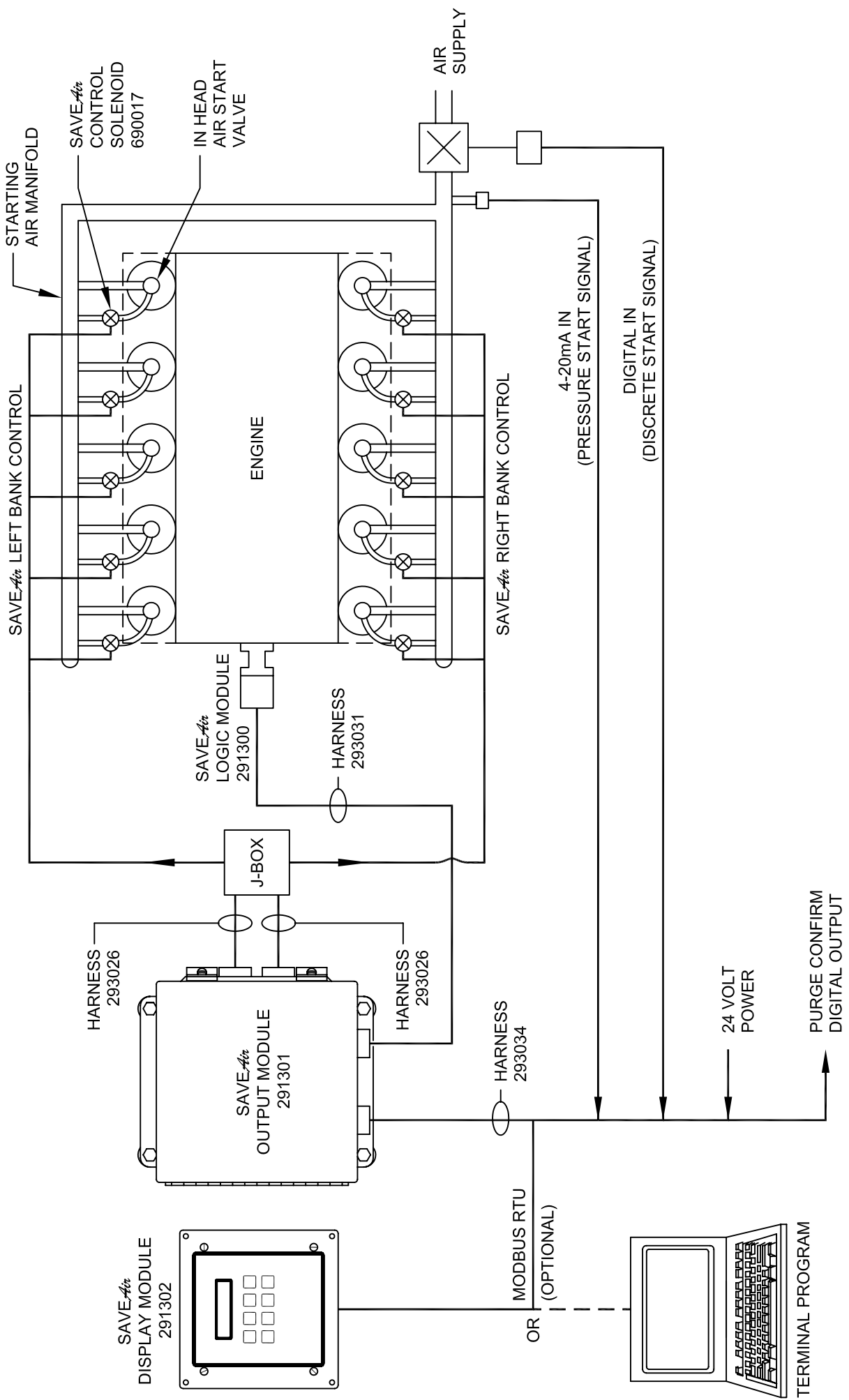

SPECIFICATION:
INPUT VOLTAGE = 24 VDC (20-32 VDC)
INPUT CURRENT = 5 ADC MAX.
OPERATING TEMPERATURE = -40°F TO +185°F (-40°C TO +85°C)

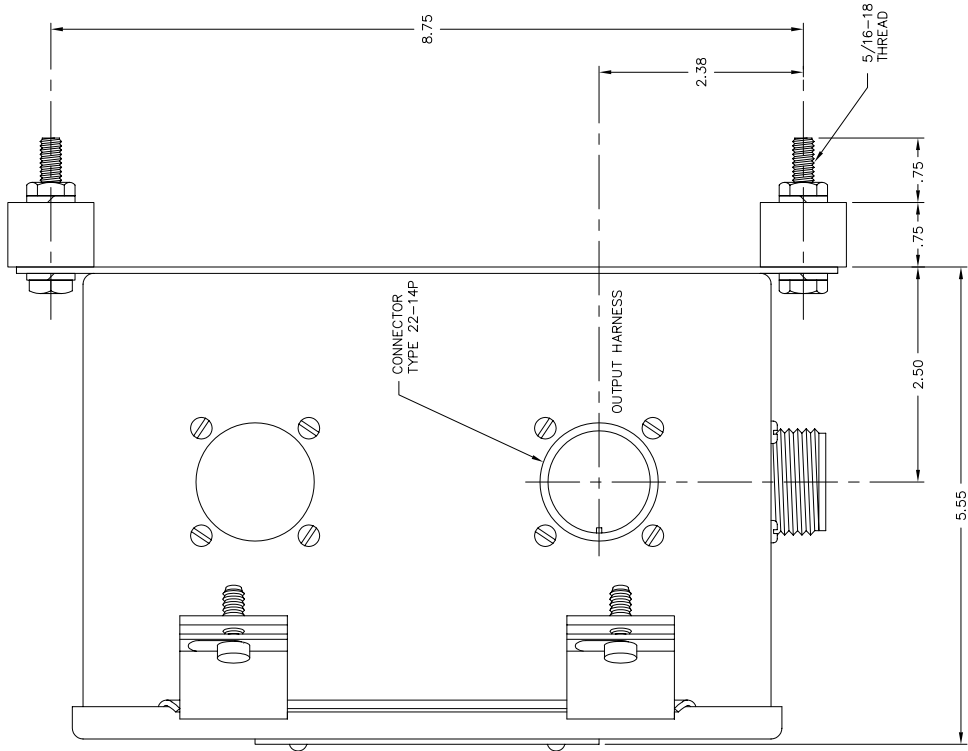
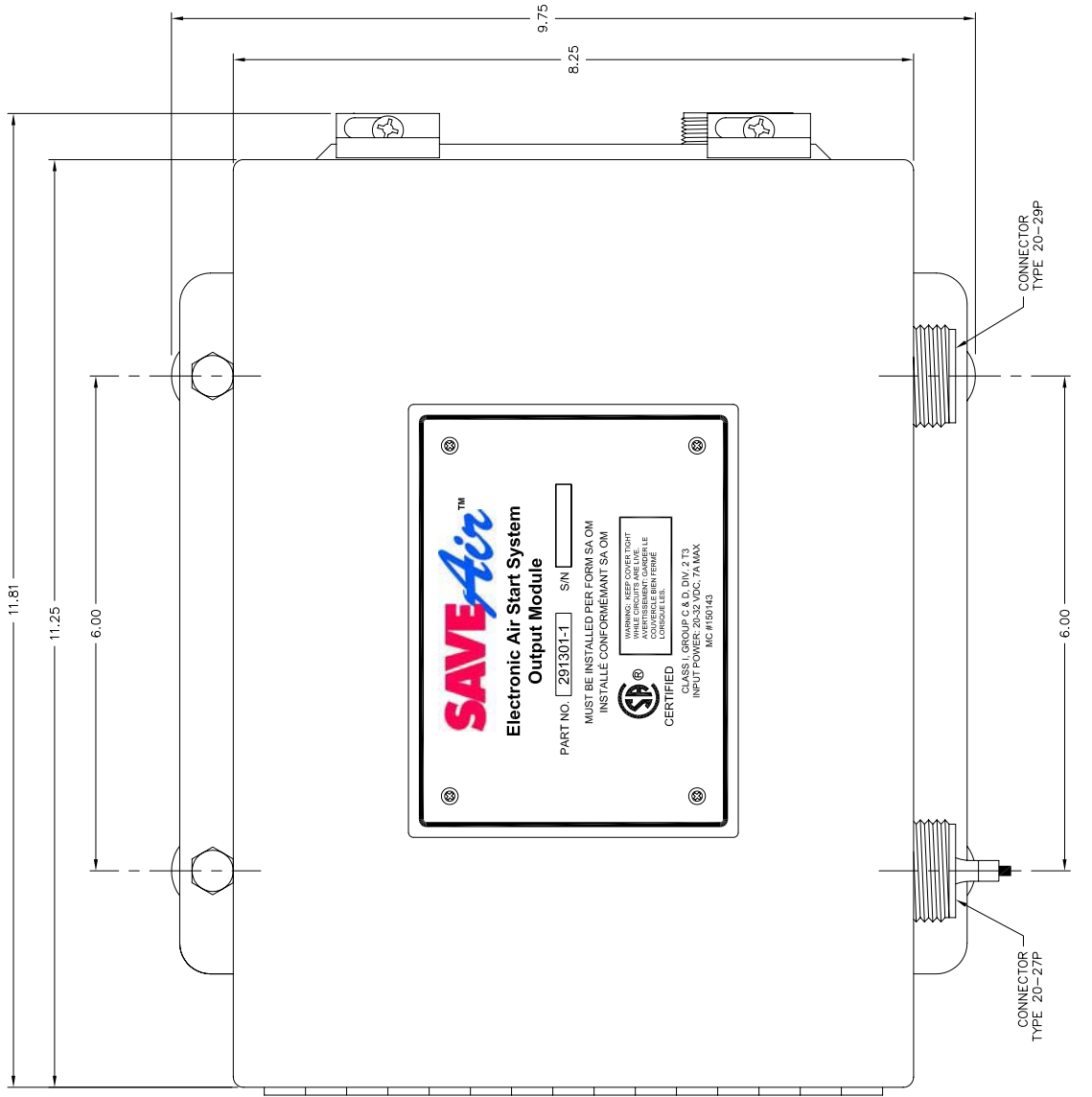

REVISIONS			TOLERANCES (EXCEPT AS NOTED)			ALTRONIC INC.		
NO.	DATE	BY	DESCRIPTION			TITLE	SALES DRAWING, OUTPUT MODULE	DRAWING NUMBER
1						REVISION	291301-1 (SAVEAIR)	
2						FRACTIONAL		
3						DRAWN BY	GET/WTP	SCALE
4						CHECKED BY		DATE
5						APPROVED BY		

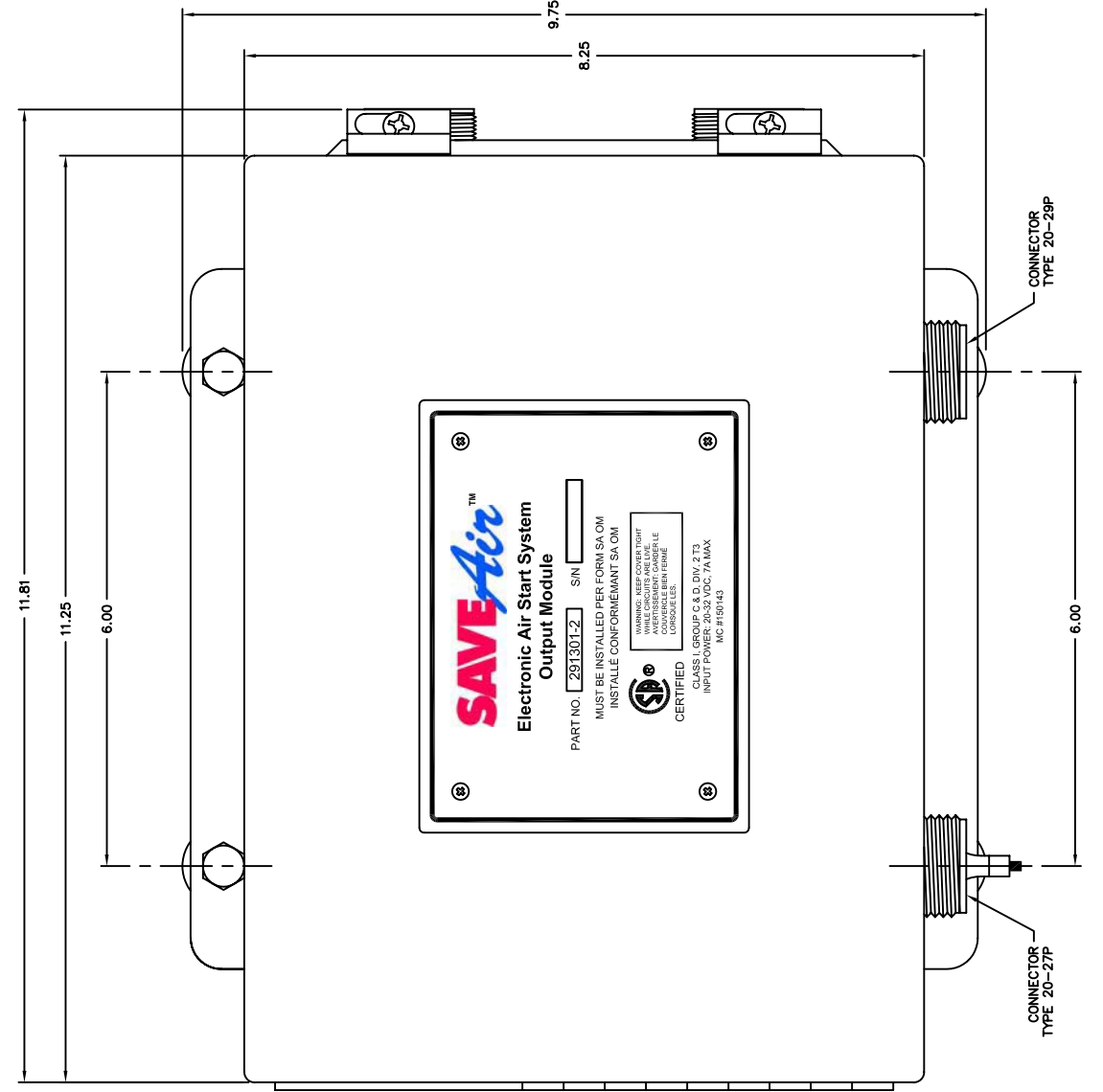

SPECIFICATION:
INPUT VOLTAGE = 24 VDC (20-32 VDC)
INPUT CURRENT = 5 ADC MAX.
OPERATING TEMPERATURE = -40°F TO +185°F (-40°C TO +85°C)

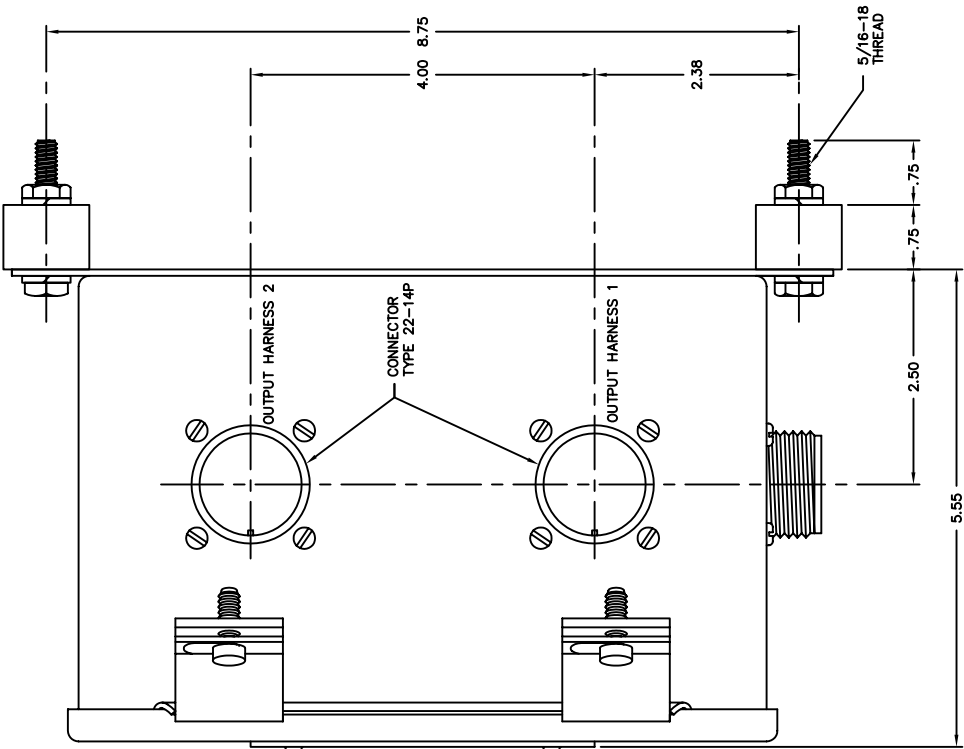

REVISIONS			TOLERANCES (UNLESS OTHERWISE SPECIFIED)			ALTRONIC INC.		
NO.	DATE	BY	DESCRIPTION	DECIMAL	FRACTIONAL	TITLE	SALES DRAWING	OUTPUT MODULE
1				.XX - .XX	1/16 - 1/8			
2				.XX - .XX	1/16 - 1/8			
3				.XX - .XX	1/16 - 1/8			
4				.XX - .XX	1/16 - 1/8			
5				.XX - .XX	1/16 - 1/8			
						DRAWN BY GET/WTP		
						CHECKED BY		
						DATE		
						3-11-05		
						DRAWING NUMBER		
						299 301-2		

SPECIFICATIONS:

- POWER: 24 VDC @ 150 mA NOMINAL, 32 VDC @ 250mA MAX.
ENCLOSURE: WEATHERPROOF, POWDER COATED ALUMINUM
FIELD CONNECTIONS: PLUG-IN TERMINAL STRIPS ON BACK
CONTROL INPUTS:
1. RS485 SERIAL COMMUNICATIONS PORT

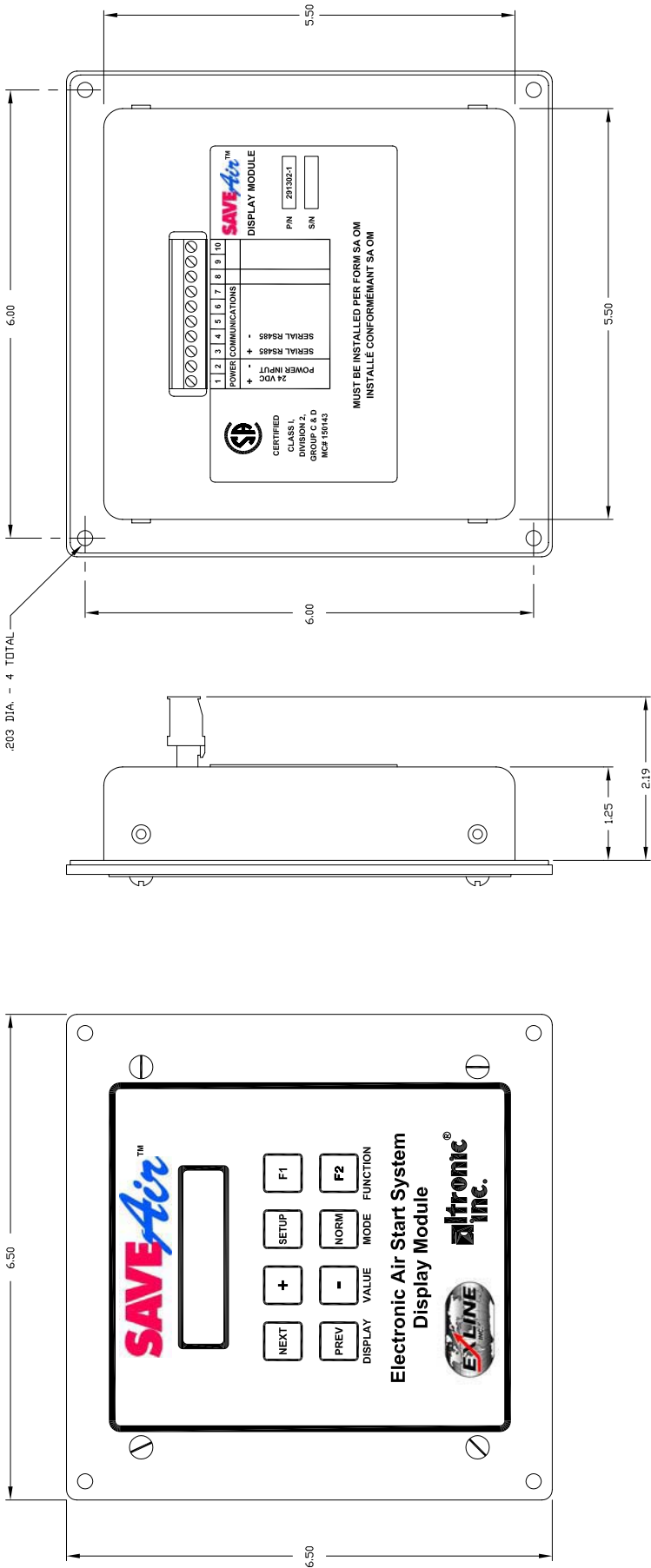

REVISIONS			TOLERANCES EXCEPT AS NOTED		ALTRONIC INC.	
NOL	DATE	BY	DESCRIPTION		TITLE	SALES DRAWING DISPLAY MODULE
1					291302-1 (SAVEAIR)	
2					DRAWN BY	GET/W/PI
3					CHECKED BY	SCALE
4					DATE	4-8-05
5					APPROVED BY	

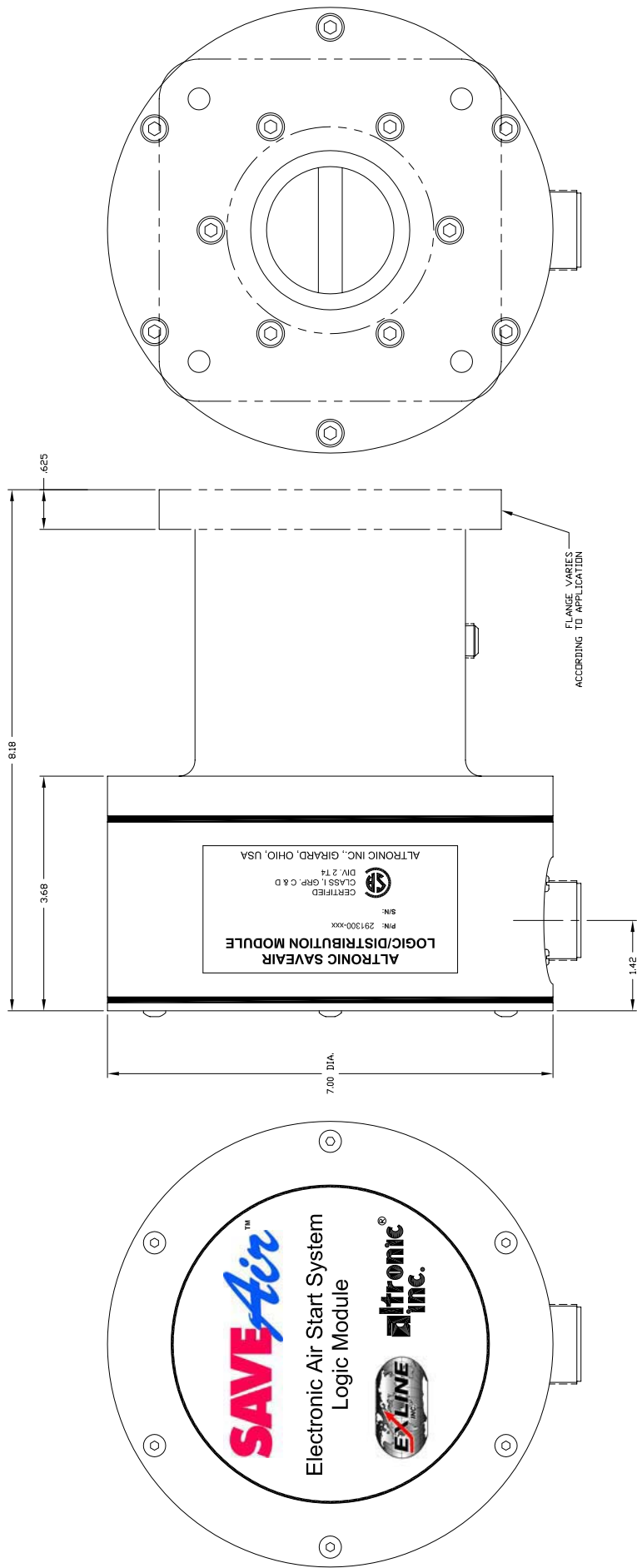

REVISIONS			TOLERANCES UNLESS NOTED		ALTRONIC INC.	
NO.	DATE	BY	DESCRIPTION		TITLE	LOGIC/DISTRIBUTION MODULE
1			DECIMAL	±.005	DRAWN BY	WTP
2			FRACTIONAL	.XX - .X00	CHECKED BY	BBB
3					SCALE	DATE
4					3-28-05	299 300
5						

SPECIFICATIONS

VOLTAGE: 24V ±10%
WATTS: 10 ±10%
MAX. PRESSURE: 250 PSI
ORIFICE SIZE: 3/64", 1/16" DIA.
DIRECT OPERATED: NORMALLY CLOSED
OPERATING TEMP.: -40°C TO +65°C
COIL RESISTANCE: 59.3 ± 8% OHMS
PORT THREAD SPEC: 1/4" NPT
BODY MATERIAL: 303 SS

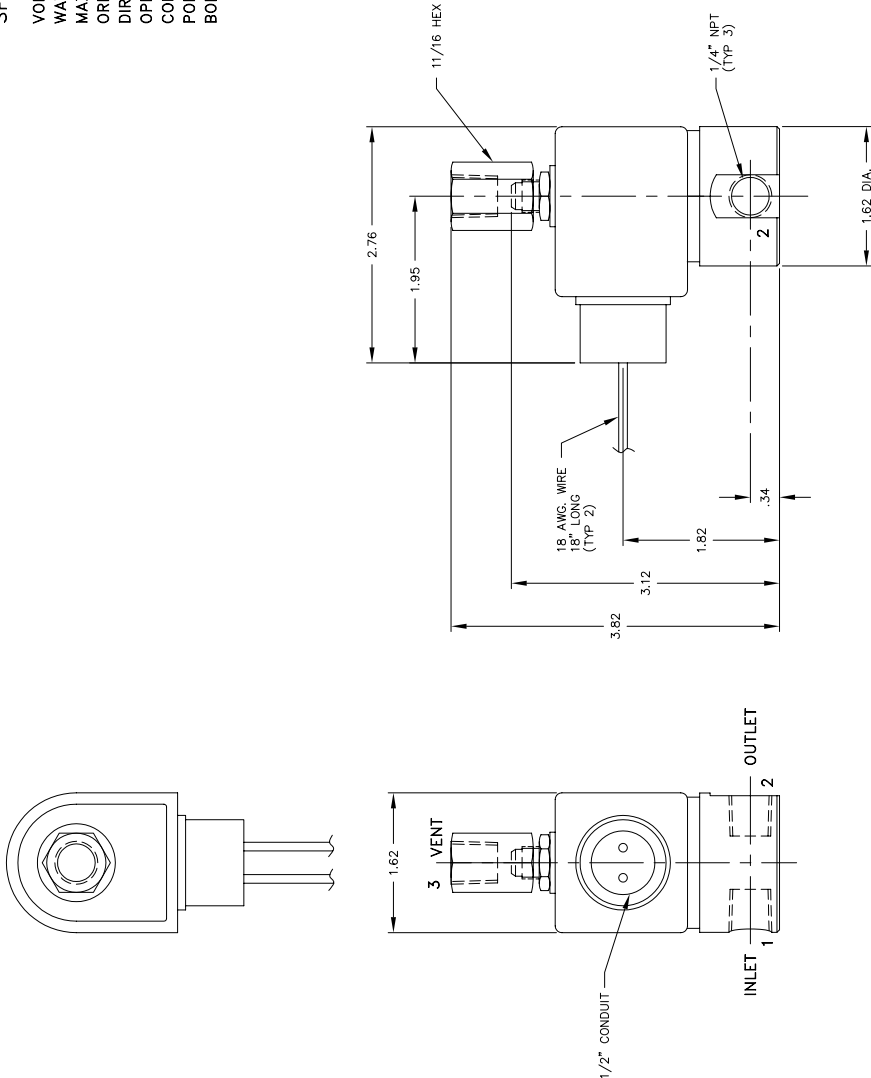

- NOTES:
- 1. A SUBSTITUTE ITEM SHALL NOT BE USED WITHOUT PRIOR QUALIFICATION BY ALTRONIC, INC. (ENGINEERING DEPT.)
 - 2. VENDOR CHANGE CONTROL AND TRACEABILITY PER SPECIFICATION 5001616.
 - 3. VALVE MUST BE CSA APPROVED FOR HAZARDOUS LOCATIONS.

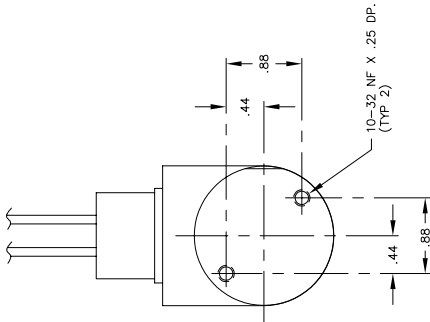

REVISIONS			TOLERANCES (EXCEPT AS NOTED)			ALTRONIC INC.		
NO.	DATE	BY	DESCRIPTION			TITLE		
0						3-WAY SOLENOID, 690017-1		
1						DRAWN BY WTP SCALE FULL		
2						CHECKED BY DATE 4-14-05		
3						DRAWING NUMBER 699 138		
4						APPROVED BY		

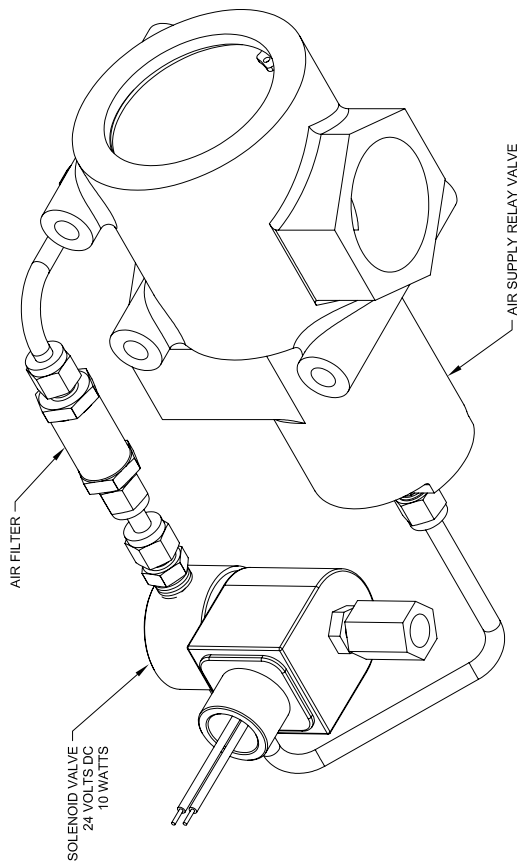
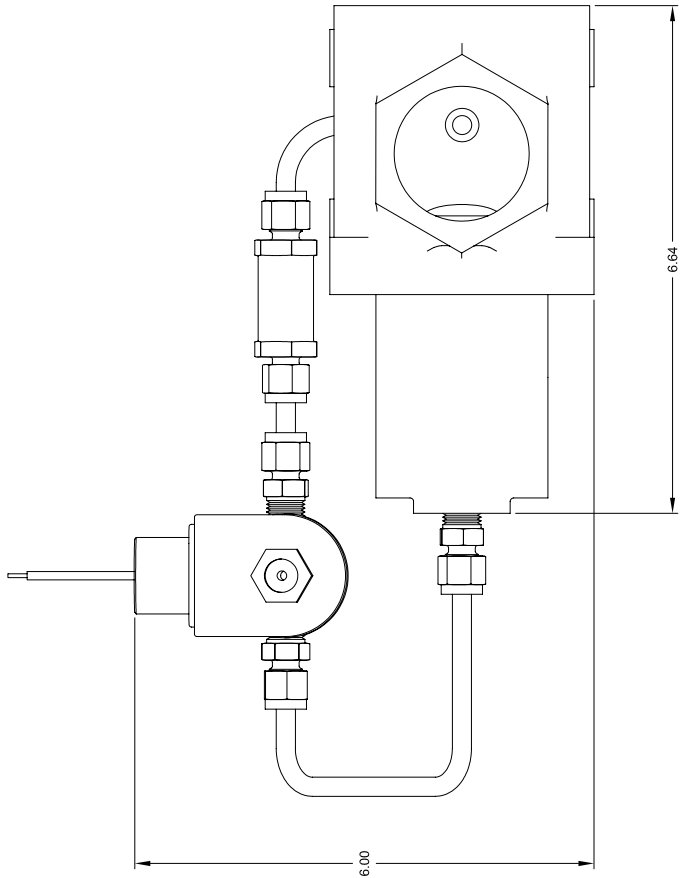
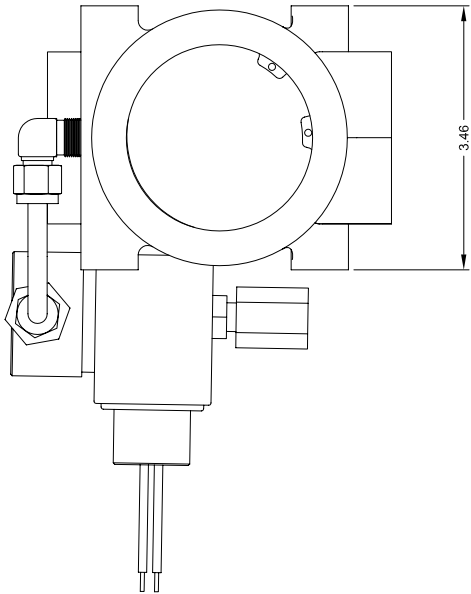
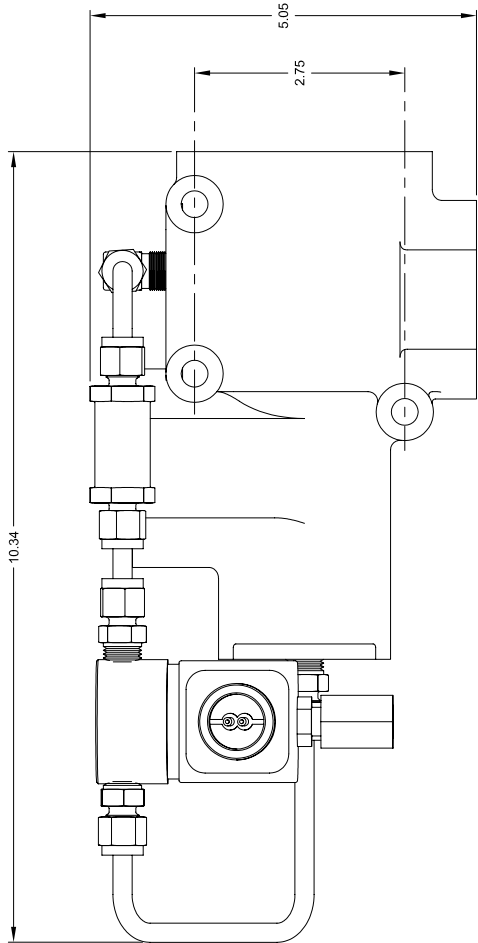

REVISIONS			TOLERANCES (EXCEPT AS NOTED)		ALTRONIC INC.	
NO.	DATE	BY	DESCRIPTION		TITLE	
1					RELAY VALVE ASSEMBLY KIT	
2					SAVE AIR (CLARK ENGINE)(690018-1)	
3					DRAWN BY WTP	DRAWING NUMBER
4					CHECKED BY .888	DATE 4-27-05
5					APPROVED BY	699 139

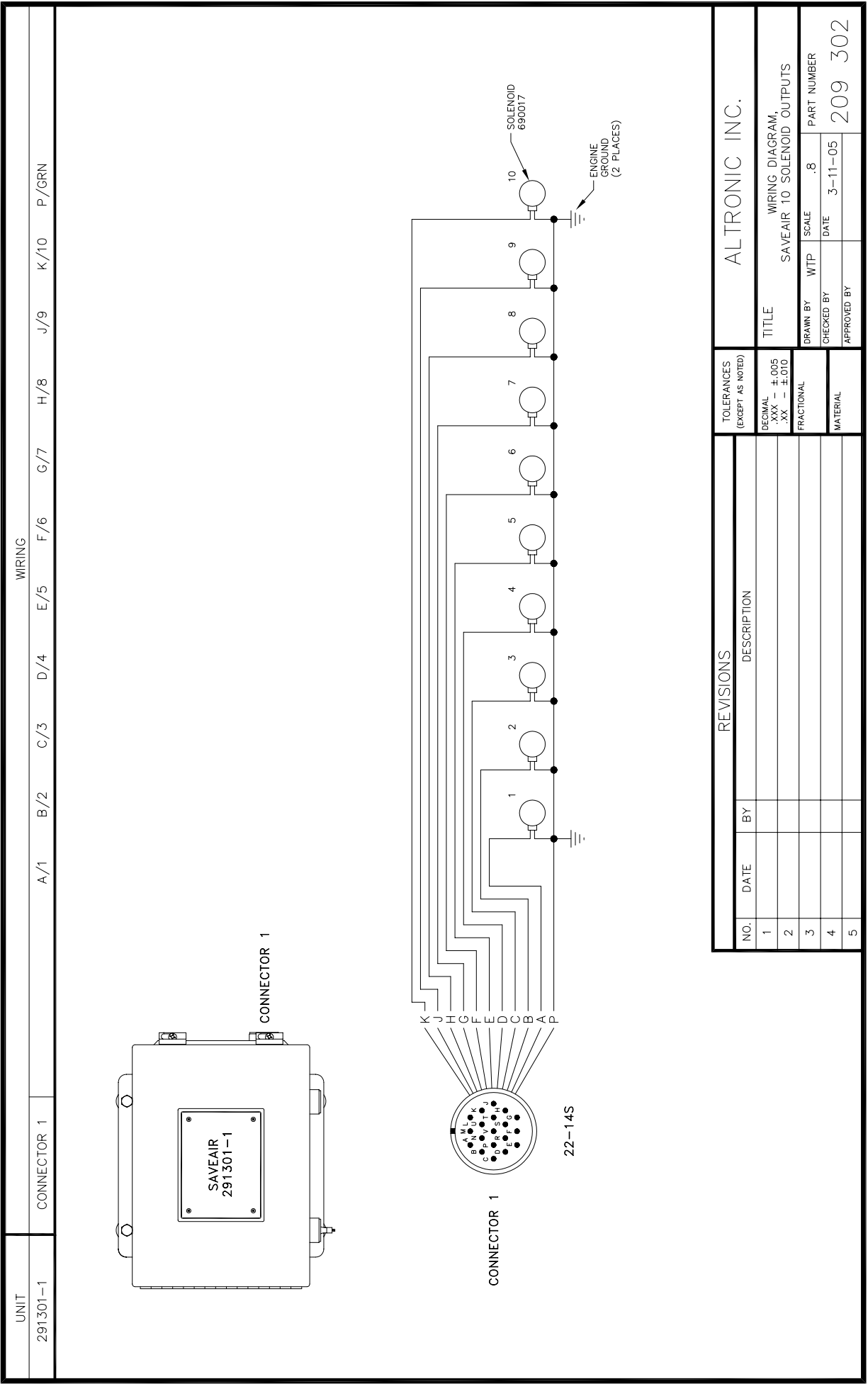

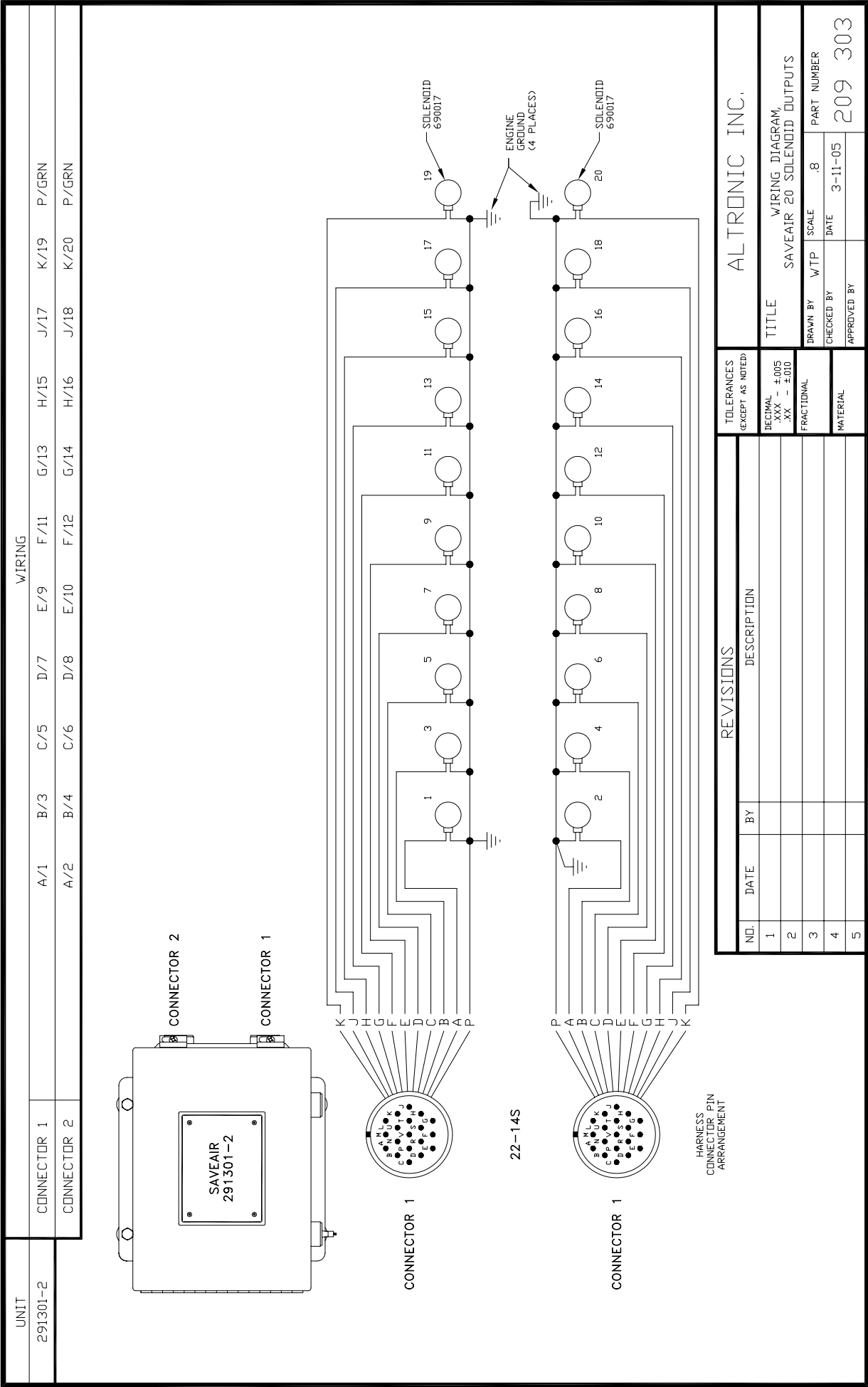

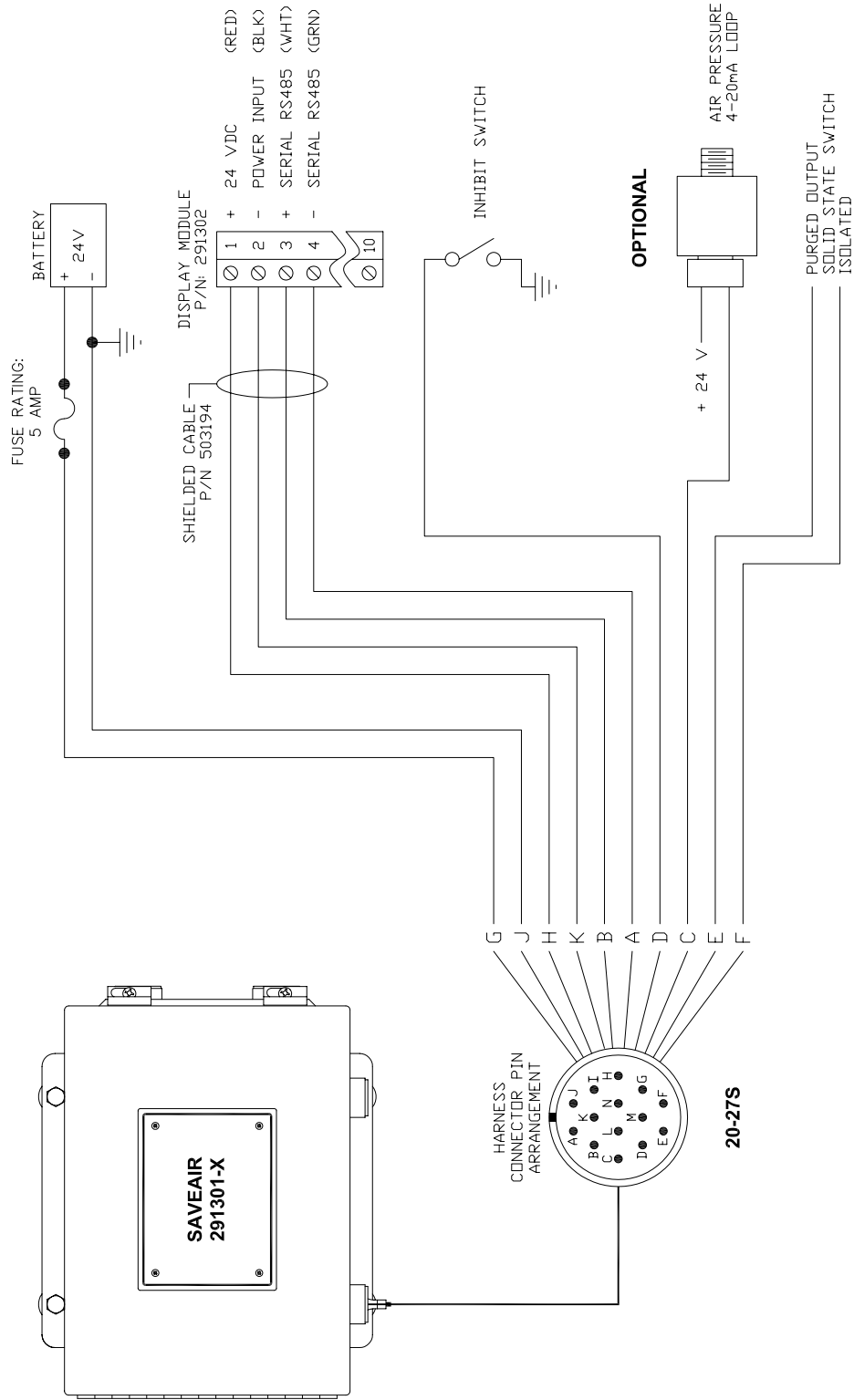

REVIEWS		TOLERANCES (EXCEPT AS NOTED)		ALTRONIC INC.	
NO.	DATE	BY	DESCRIPTION	DECIMAL .XX - +.005 .XX - ±.010	FRACTIONAL
1					
2					
3					
4					
5					

TITLE		WIRING DIAGRAM		SAVEAIR DISPLAY AND I/O	
DRAWN BY	WTP	SCALE	NONE	DRAWING NUMBER	209 304
CHECKED BY	DATE	3-28-05			
APPROVED BY					

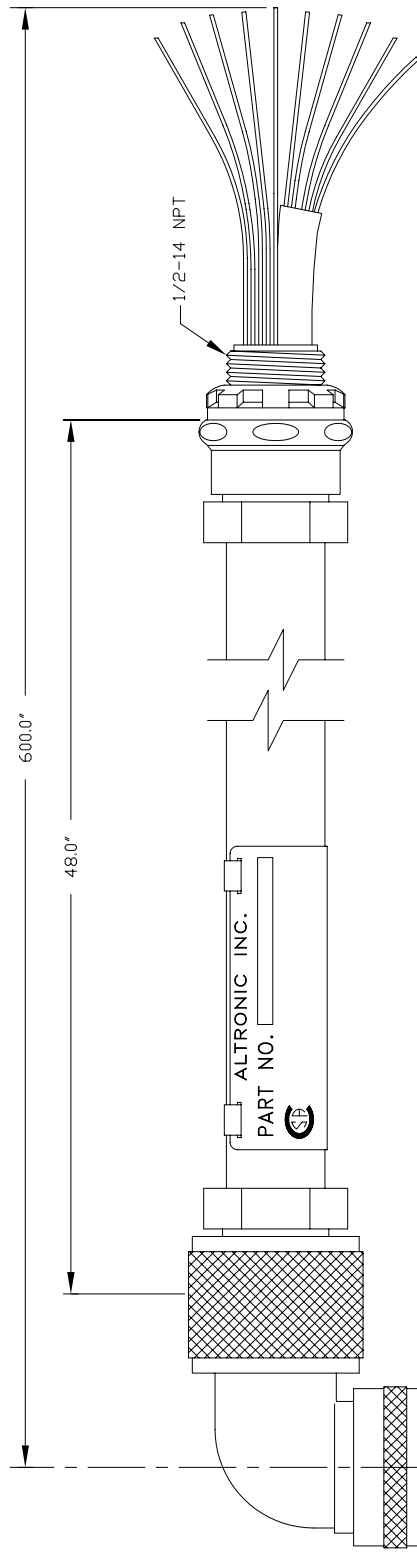

CONNECTOR PIN WIRING

A	SHIELDED GREEN
B	SHIELDED WHITE
C	WHITE - "CCC"
D	WHITE - "DDD"
E	WHITE - "EEE"
F	WHITE - "FFF"
G	WHITE - "GGG"
H	SHIELDED RED
I	N/C
J	WHITE - "JJJ"
K	SHIELDED BLACK
L	N/C
M	N/C
N	N/C

CSA CERTIFIED CLASS I, GROUP D, DIV. 2

REVISIONS				TOLERANCES (EXCEPT AS NOTED)	ALTRONIC INC.			
NO.	DATE	BY	DESCRIPTION		TITLE		SALES DRAWING, SHIELDED HARNESS (293034)	
1				DECIMAL XXX - ±.005 .XX - ±.010				
2				FRACTIONAL				
3					DRAWN BY	GET./W/P	SCALE	DRAWING NUMBER
4					CHECKED BY		DATE	
5				MATERIAL	APPROVED BY			
							299	303

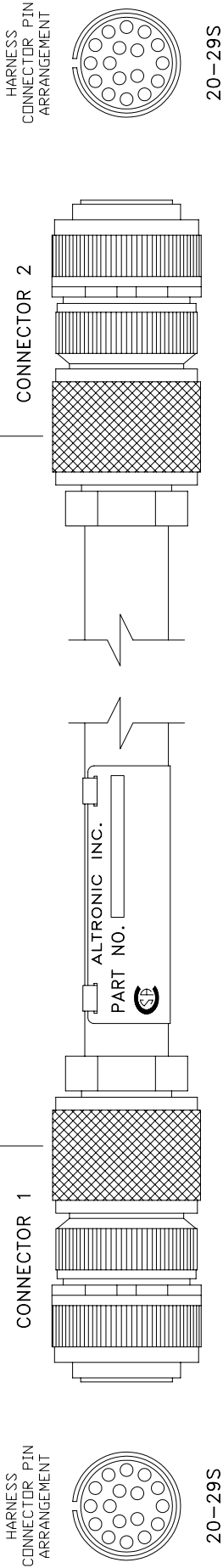

CONNECTOR 1 PIN	CONNECTOR 2 PIN
A	A
B	B
C	C
D	D
E	E
F	F
G	G
H	H
J	J
K	K
L	L
M	M
N	N
P	P
R	R
S	S
T	T

PART NO.	L1	LENGTH
293031-24		24"
293031-48		48"
293031-72		72"

REVISEMENTS		TOLERANCES (EXCEPT AS NOTED)		ALTRONIC INC.	
NO.	DATE	BY	DESCRIPTION		
1				TITLE	
2				SALES DRAWING	
3				SHIELDED HARNESS 293031	
4				DRAWN BY WTP SCALE FULL	
5				CHECKED BY DATE 8-6-97	
			DRAWING NUMBER		
			299 105		
			APPROVED BY		
			MATERIAL		

TO SHORTEN HARNESS

1. LOOSEN AND DISENGAGE NUT (2) AND REMOVE CONDUIT (1) COMPLETELY FROM CONNECTOR AND HARNESS ASSEMBLY (3).
2. REMOVE ITEMS (5), (4), AND (2) IN THAT ORDER FROM CONDUIT (1). NOTE THREADS ON (5).
3. CUT CONDUIT TO LENGTH WITH HACKSAW AND DRESS WITH FILE TO INSURE A CLEAN, SQUARE END. REMOVE FILINGS FROM INSIDE CONDUIT.
4. REINSTALL ITEMS (2), (4), AND (5) IN THAT ORDER.
5. INSTALL REASSEMBLED CONDUIT INTO (3) AND TIGHTEN (2).

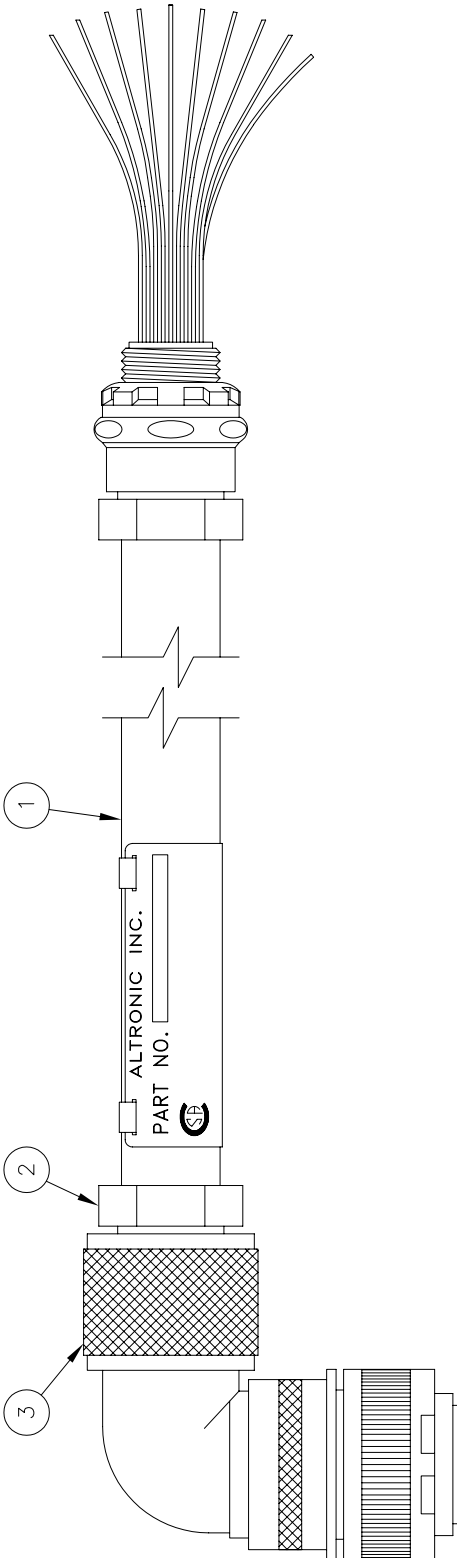
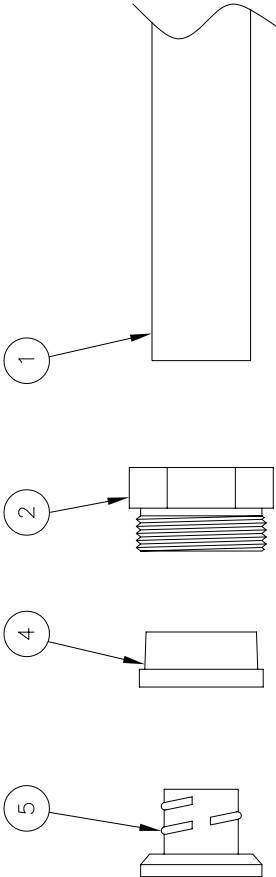

REVISIONS

NO.	DATE	BY	DESCRIPTION
1	3-14-92	WTP	REDRAWN ON CAD
2			
3			
4			
5			

TOLERANCES (EXCEPT AS NOTED)
DECIMAL .XX - +.005 .XX - +.010
FRACTIONAL
MATERIAL

ALTRONIC INC.			
TITLE			
SHIELDED HARNESS CONDUIT LENGTH ADJUSTMENT			
DRAWN BY	DWA	SCALE	NONE
CHECKED BY		DATE	5-28-85
APPROVED BY			
			PART NUMBER
			509 025